



GLASSCRAFTERS INC.

GLASSCRAFTERS, INC
193 Veterans Blvd., Carlstadt, NJ 07072

1+(800) 233-7362 (F) 1+(888) 233-7362
sales@glasscraftersinc.com

Center Mirror & Glass Shelf Installation Instructions

Congratulations on your purchase of Americas finest Mirrored Cabinet by GlassCrafters, Inc. World class engineering and state of the art design will enable you to enjoy your cabinet for many years to come.

We realize that the marketplace offers many choices and we thank you for selecting GlassCrafters for your Mirrored Cabinet needs.

The following instruction sheet must be used with the Mirrored Cabinet installation instructions and the Decorative Wall Mirror installation sheet.

To insure proper installation we recommend installation by a professional installer.

SAVE THESE INSTRUCTIONS
FOR FUTURE REFERENCE

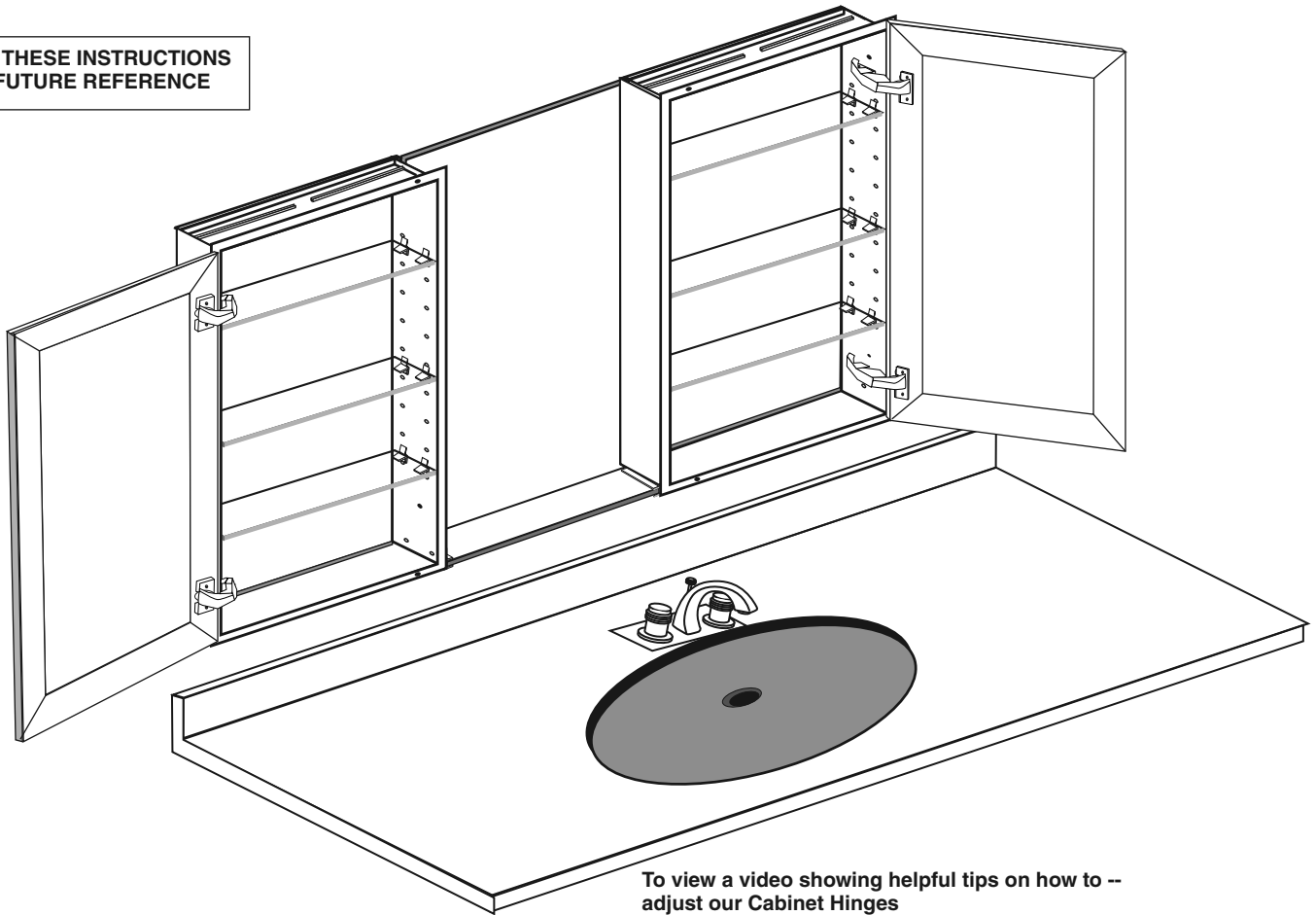

This installation manual serves as an addendum to the complete line of GlassCrafters Mirrored Cabinets including the 4" & 6" deep models.

The general parts list pictured on page 2 shows the single images of a part.

Separate manuals with installation instructions and parts list for the Mirrored Cabinets and for the Decorative Wall Mirror (as shown completely installed above) are each separately included with those items.

To view a video showing helpful tips on how to -- adjust our Cabinet Hinges or to install our Mirrored Side Kits, please go to: GlassCraftersMirroredCabinets.com and navigate to the cabinet product that you are installing.

Simply click on the installation tab (located below the product images) to view our installation videos.

If your unit is an electrified unit you should have the GC-Electric Option manual packed with your unit. If it is not available for installation go on line and download the product manual you need or contact your dealer.
ALL ELECTRIC UNITS REQUIRE INSTALLATION BY A LICENSED ELECTRICIAN.

Please use extreme care while unpacking and handling your GlassCrafters' Mirrored Cabinet. Report any damage immediately to our GlassCrafters customer service team at 800-233-7362, Monday thru Friday from 8:00 am to 5:00 pm (EST).

Revised 05/2016

Center Glass Shelf with Decorative Wall Mirror with Two Mirrored Cabinets

Unpack all parts carefully and protect Glass and Mirror parts during installation.

Tools Required for Installation

GlassCrafters recommends the following tools to properly and safely install your Mirrored Cabinets.

- A. Safety Glasses -- should be worn at all times
- B. Tape Measure
- C. Level
- D. #2 Phillips Head Screw Driver
- E. Power Screw Driver
- F. Electric Drill
- G. 8mm 3/16" Masonry Drill Bit
- H. 7/32" Drill Bit
- I. Non Ammonia Household Glass Cleaner
- J. Soft Paper Towels

Parts supplied with this shelf kit --

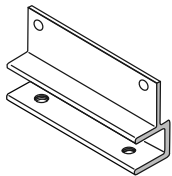

4" Clip Holder (2)

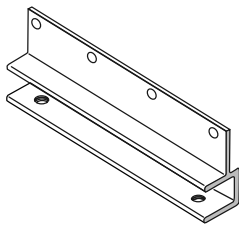

6" Clip Holder (2)



Clip Holder Screws (4)
6/32" x 3/4 x #2
4" clip - (4)



Nylon Screws (4)
1/4" x 20

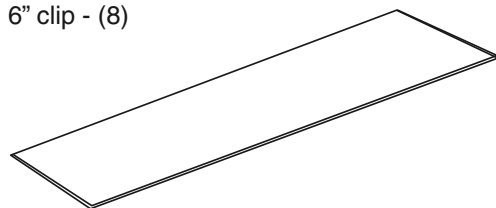

Glass Shelf

Cleaning Recommendations:

Never use abrasive cleaners or cleaners containing ammonia. This may cause chemical damage to the mirror and void the warranty.

For cleaning the mirror, we recommend using ammonia free Sprayway brand glass cleaner, which is available at a variety of retail outlets.

www.spraywayinc.com/content/glass-cleaner



This Center Mirror Shelf is installed on surface mounted cabinets only. Be sure to provide at least 1 inch of clearance above any faucet or other obstruction.

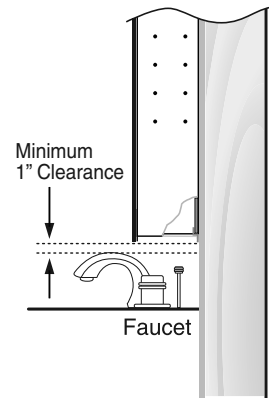

SURFACE MOUNT

The Glass Shelf Clip Holder must be installed on each cabinet **BEFORE** the cabinet is surface mount installed. Determine the left and right cabinet for the proper positioning of the clip holders.

To insure proper installation in complete compliance with your warranty, we recommend installation by a professional installer.

INSTALLATION STEPS:

Step 1 -- Remove the existing Phillips head cabinet screws. Place the clip holder in position and reinstall the cabinet screws.

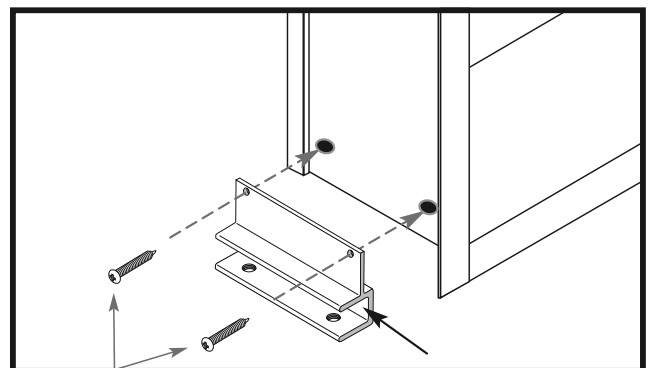
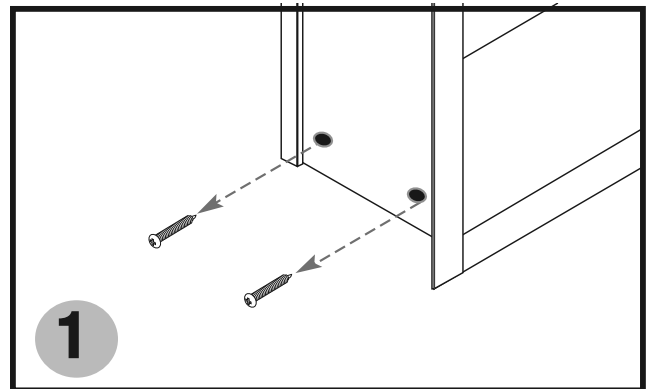

Step 2 -- Measure the overall dimension of both cabinets and the center mirror.
Mark the center line of the installation location.
Mark for the center mirror width.

NOTE: Refer to the installation manuals supplied with the Mirrored Cabinet and the Decorative Wall Mirror for complete parts list and step-by-step instructions.

Step 3 -- Install the inside facing Side Mirror Kit on both Cabinets.

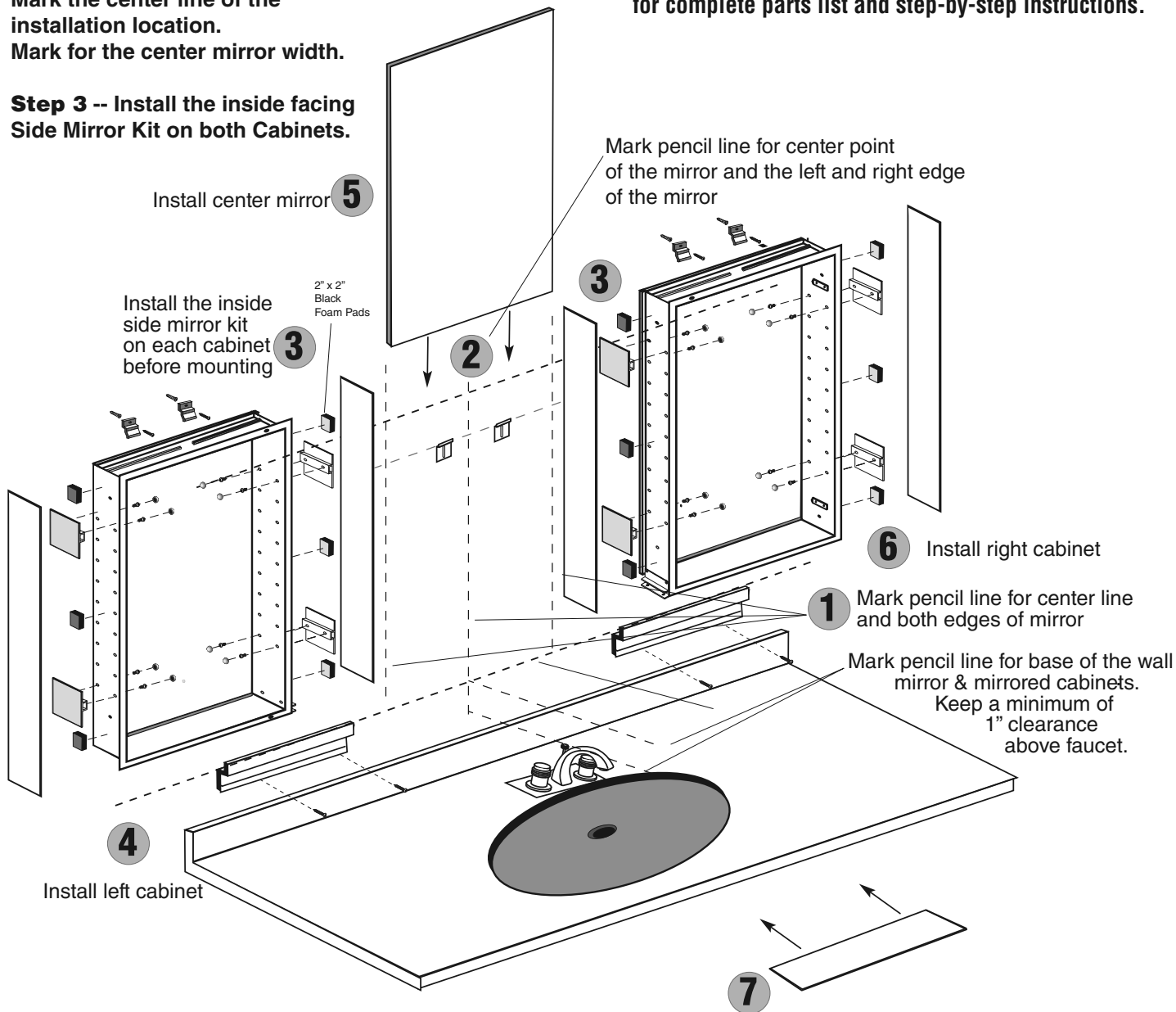

Step 4 -- Follow the GlassCrafters Surface Mount installation instruction and install the left cabinet flush to the left side of the mirror position.

Step 5 -- Install the center Mirror using the installation sheets supplied for reference.

Step 6 -- Install the right medicine cabinet flush to the right side of the center mirror.

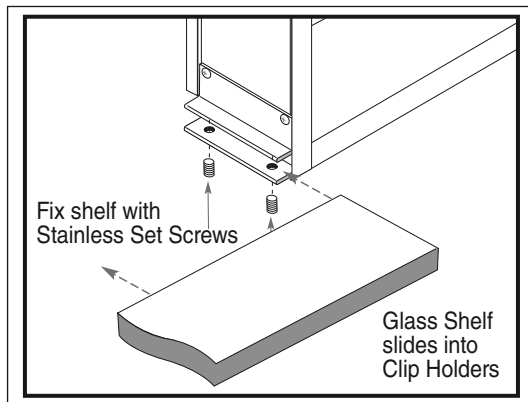
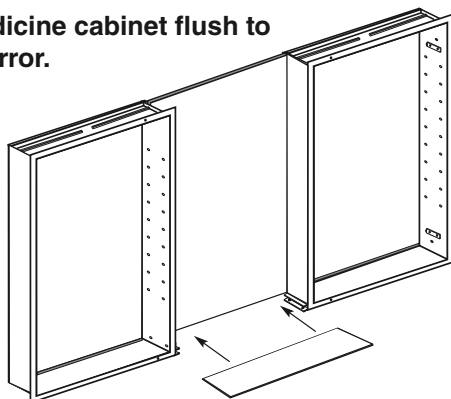

Step 7 -- Carefully slide the 4" or 6" center glass shelf in the Clip Holders. Gently turn the M8 x 1.25 Stainless Set Screws to hold the Glass Shelf in place.

Center Glass Shelf with Decorative Wall Mirror with Two Mirrored Cabinets

Step 8 -- Install the two outside Side Mirror Kits following instructions supplied with the cabinet.

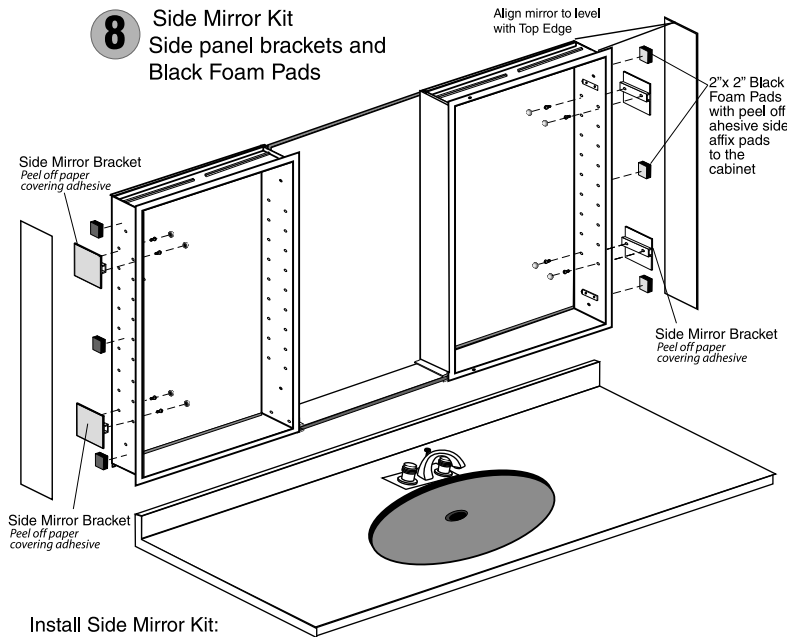

Install Side Mirror Kit:

- Install brackets
- Clean back side of mirror with alcohol pads
- Peel-off paper covering the adhesive tape on brackets (this holds the mirror in place)
- Align mirror top and bottom
- Press firmly in place (Do not try to remove mirror as it will break)
- Install foam pads on the cabinet above, below and in between the brackets

Side Mirror Kit Installation

For surface mounted 4" & 6" Mirrored Cabinets and 6" semi-recessed Mirrored Cabinets.

- 1) Attach the side mirror kit brackets thru the pre-punched holes in your cabinet.
- 2) Try to use the first row from the top and bottom of your cabinet. Using the eight 10-32 x 1/2" screws fasten the brackets and finish with screw caps.
- 3) Attach the 2" x 2" foam pads to the outside cabinet wall above, below and in between the position of the brackets.
- 4) Clean the backside of the side mirror kit panel with the Alcohol pads. Check alignment before you attach the mirror to be sure it will align even with the top of the cabinet.
- 5) Peel off paper covering of the adhesive tape on the side kit brackets pads. (This holds the mirror in place). Carefully align the mirror to the cabinet evenly on all four sides. Press firmly into place and attach to the side kit mirror to the cabinet body.

(Note: Once installed, do not try to remove the mirror as it will break.)

Side Mirror Kit parts list:

- 4 Mirror side panels to match the model height ordered
- 8 Side kit brackets
- 12 2"x2" Black Foam Pads with double sided tape
- 16 Screws, 10-32 x 1/2"
- 16 Screw Caps (part # 434-00)
- 8 Alcohol Pads

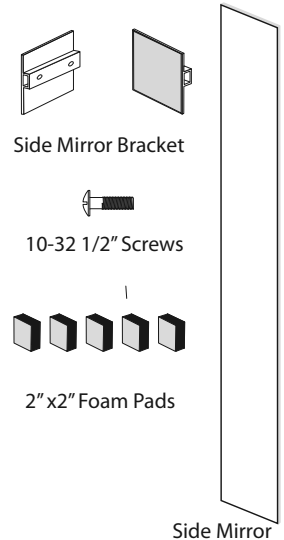

To view a video showing helpful tips on how to install mirrored side kits and to adjust the door hinges, please go to GlassCraftersMirroredCabinets.com and navigate to the cabinet product that you are installing. Simply click on the installation tab (located below the product images) to view our installation videos.

WARRANTY

GlassCrafters, Inc. offers a Limited 3 Year Warranty on all mirrored cabinet products. GlassCrafters' warranty provides the original purchaser a guarantee that it will replace or at its own discretion repair products shown to have substantial defects in workmanship or materials. These claims must be filed with your dealer or professional installer and forwarded in writing to GlassCrafters within three years of the delivery date to the end user of the product. GlassCrafters shall not be responsible for any installation or removal costs. This warranty does not apply to the following, chemical or natural corrosion of the mirror. The use of abrasive cleaners or cleaners containing ammonia will cause chemical damage to the mirror, voiding this warranty.

The GlassCrafters warranty does not cover product that is damaged in shipping, accidents in handling during installation or if the reported defects are a result of faulty installation, abuse, misuse, abnormal wear, poor maintenance, accident or repairs by service personnel other than the original professional installer as authorized by GlassCrafters. After the three year period GlassCrafters shall not have any further obligation, expressed or implied including merchantability under the Limited Warranty.

Blum hinges and soft closing cushions have a separate lifetime warranty from Blum, Inc. This warranty is against defects in materials and workmanship as long as the original consumer owns the product. This is a warranty of replacement. After verification of defect, Blum, Inc. will send replacement hardware without charge.

GlassCrafters shall not have any liability for any consequential damages stemming from or in connection with the use per performance of this product. Prevailing state law on the limits of the implied warranty will apply.

The liability of GlassCrafters under any implied or expressed warranty, including merchantability, is expressly limited to the terms of this warranty. Any claim under this warranty must be made directly to the dealer of record.

Permission to return any merchandise under this warranty must be authorized in writing by GlassCrafters and must include prepaid shipping by the purchaser.



GLASSCRAFTERS, INC
193 Veterans Blvd., Carlstadt, NJ 07072

1+(800) 233-7362 (F) 1+(888) 233-7362
sales@glasscraftersinc.com