



GLASSCRAFTERS INC.

GLASSCRAFTERS, INC  
193 Veterans Blvd., Carlstadt, NJ 07072

1+(888) 683-1362 -- (Fax) 201-525-1117  
sales@glasscraftersinc.com

# MATRIX™ series

## Frameless Sliding Door with Fixed Panel Shower/Tub Enclosure Installation Instructions

The following instruction sheet is for the installation of the models:

**SHOWER ENCLOSURES -- 76" HIGH -- 3/8" Glass:**

**XS-48T-38**, 45"- 48"w X 76"h ; **XS-54T-38**, 51"- 54"w X 76"h ; **XS-60T-38**, 57"- 60"w X 76"h; **XS-66T-38**, 63"- 66"w X 76"h

**TUB ENCLOSURES -- 66" HIGH -- 3/8" Glass:**

**XT-54-38**, 57"- 60"w X 66"h ; **XT-66-38**; 63"- 66"w X 66"h

*All Units are available in three finishes: Brushed Stainless Steel (BSS), Polished Stainless Steel (PSS) or Iron Black (IBK)*

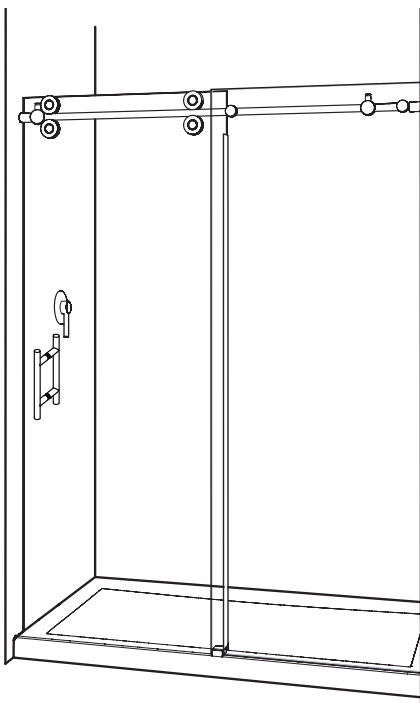

Shower Enclosure

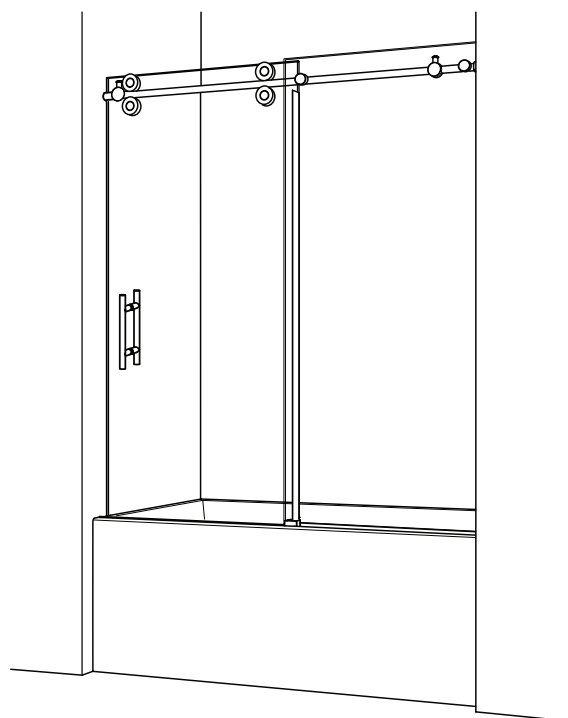

Tub Enclosure

### FOR BEST RESULTS

*GlassCrafters recommends the installation be  
performed by a trained installer.*

**INSTALLING  
THESE UNITS  
REQUIRES  
2 PERSONS**

**SAVE THESE INSTRUCTIONS  
FOR FUTURE REFERENCE**

**WARNING: TO INSTALL ON CAST IRON, FIBERGLASS, ACRYLIC OR RESIN TUB OR SHOWER BASE**  
*Check with the tub or shower base manufacturer to determine the tooling required.*

Please use extreme care while unpacking and handling your GlassCrafters' Shower or Tub Enclosure. If you need replacement parts or have installation questions and to report any damage contact our GlassCrafters' customer service team at 888-683-1362, Monday thru Friday from 8:00 am to 5:00 pm (EST).

Installation shall be made according to manufacturers' instructions and drawings.

GlassCrafters recommends the installation be performed by a trained installer.

**CAUTION:** Risk of injury or product damage. Do not attempt to cut tempered glass.  
**IMPORTANT!** Children should be supervised at all times while in Tub/Shower Enclosure.  
**IMPORTANT!** Never use Door Handle to support yourself. This is for towels or wash cloths only.  
**PLEASE STOP THE INSTALLATION AND CONFIRM WITH FACTORY IF THE ACTUAL NUMBER OR TYPE OF PARTS IS DIFFERENT**

**Tools Required - For installation of Your Shower Enclosure**

Safety glasses  
Measuring tape  
Pencil  
Hack saw or chop saw  
(for stainless steel)  
Miter Box or Square  
Level  
Electric Drill  
Center Punch  
Rubber Mallet  
Drill bit, 5/16" masonry  
(for installation on ceramic  
tiles or marble)  
Power screwdriver  
#2 phillips screwdriver  
Caulking gun  
Cutting Pliers  
Suction Glass Lifters  
(rated for more than 100 lbs)

**WARNING: TO INSTALL ON CAST IRON,  
FIBERGLASS, ACRYLIC OR RESIN TUB  
OR SHOWER BASE**  
*Check with the tub or shower base  
manufacturer to  
determine the tooling required.*

**THIS MANUAL IS FOR INSTALLATION OF THE MATRIX SERIES™  
FRAMELESS -SLIDING DOOR WITH FIXED PANEL  
FOR SHOWER STALL OR TUB ENCLOSURES**

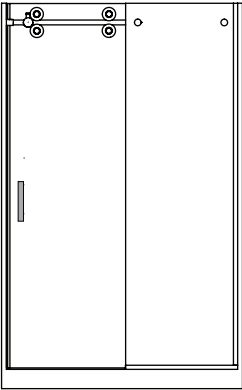

STALL

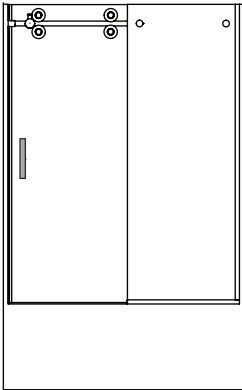

TUB

**Parts Description**

ITEM NO.	DESCRIPTION	QTY.
#6.	Glass Door	1
#7.	Fixed Panel	1
#12.	Fixed Panel Base Channel	1
#15.	Base End Cap	1
#17.	Fixed Panel Vertical Wall Channel	1
#13.	Center Guide	1
#4.	Roller Bar	1
#5.	Roller Bar Wall Brackets & Sleeves	2
#3.	Glass Screw Assemblies	2
#1.	Door Roller Assemblies	4
#2.	Roller Door Stops	2
#14.	Door Curb Dam	1
#11.	Handel Assembly	1
#8.	"H" Vinyl Splash Guard	1
#9.	"A" Vinyl /Bumper	1
#10.	Flat Head Screws, #8 x 1 1/4"	7
#10.	Plastic Wall Anchors	7
#18.	Hex Key Set (4)	1

**ASSEMBLY AND INSTALLATION INSTRUCTIONS:**

**GlassCrafters recommends the installation be performed by  
a trained installer.**

- Read the manual and become familiar with the steps involved in installation.
- This product requires **Two Persons** for safe installation.
- Always wear safety glasses during this installation.
- The proper dimensions for this installation were submitted at the time of order. The two doors may overlap to accommodate minor smaller opening. One end of the Header may be cut with a Hacksaw for stainless steel, but it must fit completely in the Header Wall Brackets for a safe installation.
- When installing any mechanical parts through the pre-drilled holes in the glass door and panel be sure to use the gaskets and bushings supplied between any metal element and the glass. **Do not over tighten any fittings.**
- If the installation is over ceramic tiles the wall Jamb must lay flat on these tiles for the entire height of the unit.
- Silicone Sealant is used to seal some parts during installation and the inside of the enclosure as shown in Step 20 (page19). Do not caulk from the outside of the enclosure.

**IMPORTANT: Determine if your Tub/Shower Stall Enclosure is Level and Walls are plumb.  
3/8" max. OOS (Out Of Square) for the door side,  
5/8" max.OOS (Out Of Square) for the panel side.  
(Add 3/8" max. OOS (Out Of Square) on  
the bottom base of enclosure.)**

**If your unit is out-of-plumb greater than the above  
dimensions STOP! and call Customer Service.**

**The Phone number is 1-888-683-1362 .**

If they are Level/Plumb, or out of Plumb for less than  
dimensions above proceed with installation.

**SPECIAL NOTE:**

**2 5/8" MINIMUM CURB WIDTH REQUIRED.**

- Unpacking:**
- A box Cutter should not be use to open any box.
  - Please remove all staples from the box prior to unpacking metal and glass.
  - Stand Panels upright on a cushioned base, such as a piece of carpet or towel.
  - Never place glass directly on hard surfaces.
  - Any assembly that requires the panel to lay flat must be on a cushion surface.

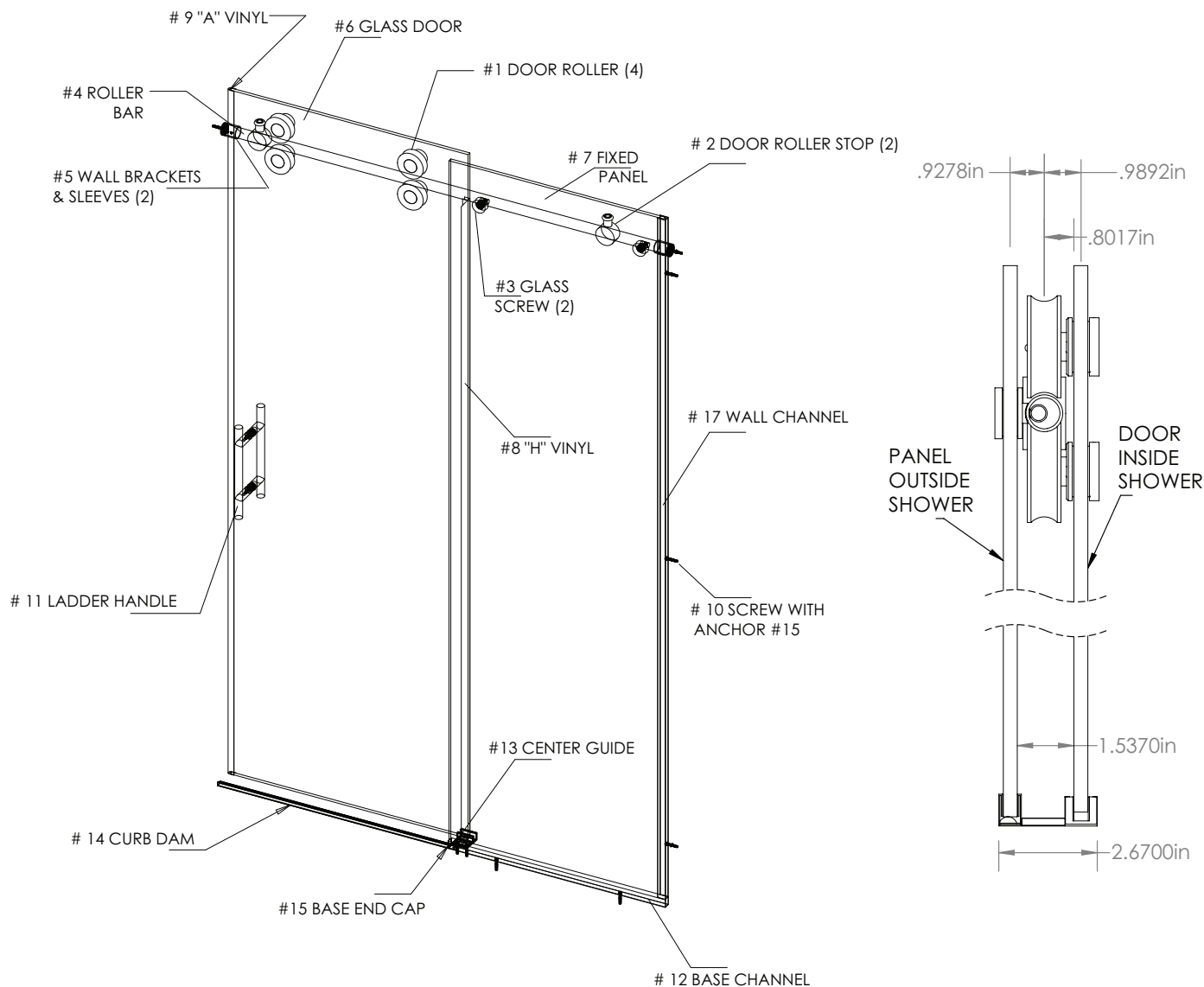

**CAUTION** Risk of injury or product damage. Do not attempt to cut tempered glass.

**IMPORTANT!** Children should be supervised at all times while in Tub/Shower Enclosure.

If you need replacement parts, do not return this item to the store/showroom, call Customer Service for an immediate, courteous response.

When Ordering Replacement Part Please Specify The Model Number, Item Number & Part Description.

Save these Installation Instructions For The Future Reference And In The Event You Need To Order Replacement Parts.

### Tools Required - For installation of Your Matrix Unit

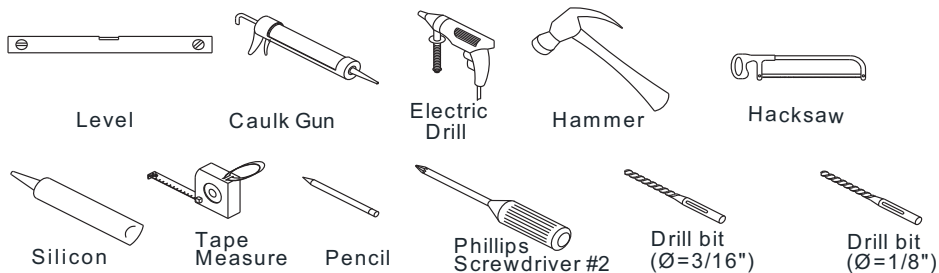

## GLASS DOOR

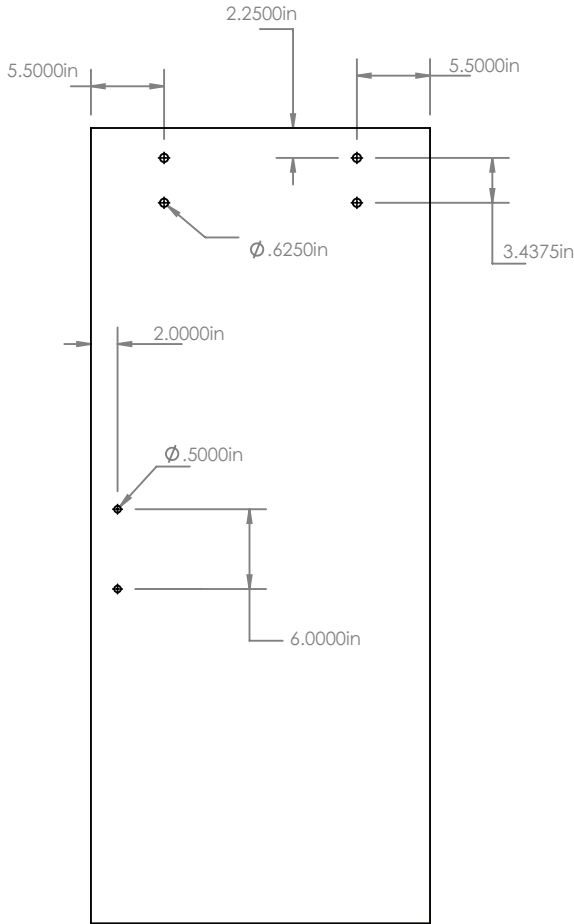

## GLASS PANEL

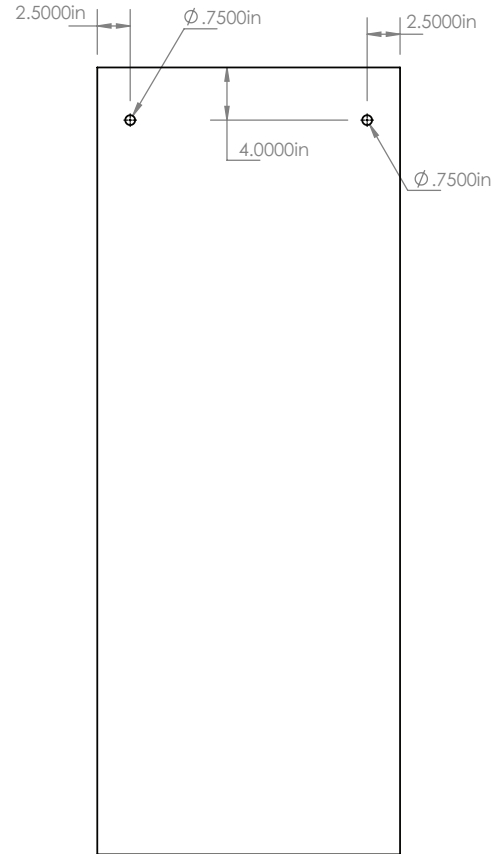

	XS-48T-38	XS-54-38	XS-60T-38	XS-66T-38	XT-60T-38	XT-66-38
OPENING MIN	45"	51"	57"	63"	57"	63"
OPENING MAX	48"	54"	60"	66"	60"	66"
OVERLAP MAX	4"	7"	7"	7"	7"	7"
OVERLAP MIN	1"	1"	1"	1"	1"	1"
WALK THROUGH MIN	18.5"	18.5"	21.5"	24.5"	21.5"	24.5"
WALK THROUGH MAX	21.5"	24.5"	27.5"	30.5"	27.5"	30.5"
HORIZONTAL CHANNEL SIZE	23.25"	26.25"	29.25"	32.25"	29.25"	32.25"
VERTICAL CHANNEL SIZE	72.125"	75.125"	75.125"	75.125"	65.125"	65.125"
BAR SIZE	50.5"	56.5"	62.5"	68.5"	62.5"	68.5"
FIRST HOLE LOCATION	2.375"	2.375"	2.375"	2.375"	2.375"	2.375"
SECOND HOLE LOCATION	20.375"	23.375"	26.375"	29.375"	26.375"	29.375"
CRUB DAM CUT SIZE	27.75"	30.75"	33.75"	36.75"	33.75"	36.75"
"A" VINYL SIZE	76"	76"	76"	76"	76"	76"
"H" VINYL SIZE	76"	76"	76"	76"	76"	76"
DOOR GLASS WIDTH	25.5"	28.5"	31.5"	35.5"	31.5"	34.5"
DOOR GLASS HEIGHT	75.5625"	75.5625"	75.5625"	75.5625"	65.5625"	65.5625"
DOOR HANDLE HOLE HEIGHT FROM BOTTOM	31"	31"	31"	31"	25"	25"
PANEL GLASS WIDTH	23"	26"	29"	32"	29"	32"
PANEL GLASS HEIGHT	75.75"	75.75"	75.75"	75.75"	65.75"	65.75"

**IMPORTANT: Read all instructions carefully and become familiar with all parts before installation.**

## PARTS LIST

DOOR ROLLER #1

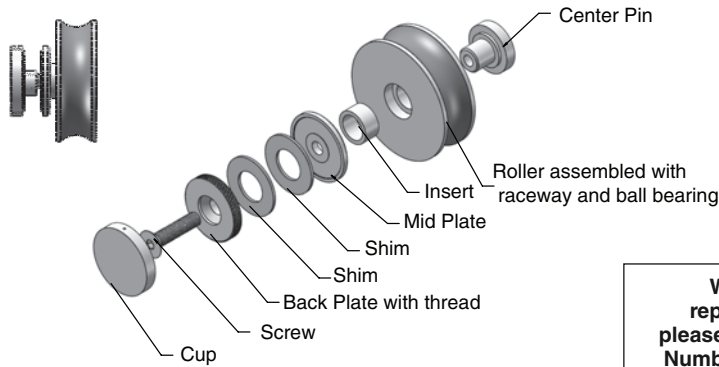

WALL BRACKET #5

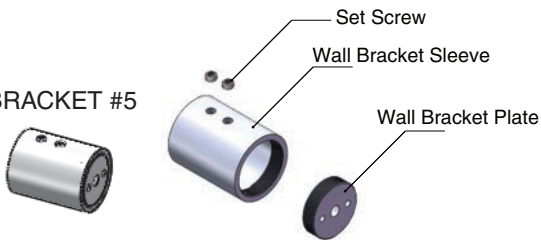

GLASS SCREW ASSEMBLY #3

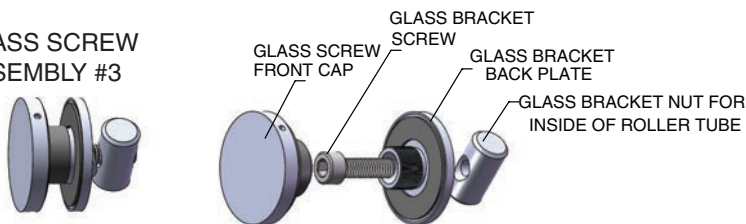

CENTER GUIDE #13

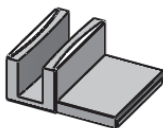

GUIDE INSERT For 3/8 Glass

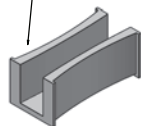

Guide Cover Plate



DOOR ROLLER STOP #2

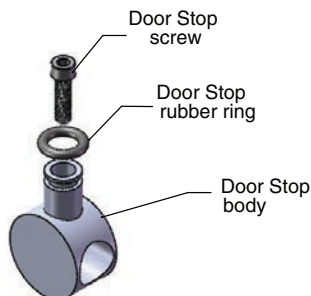

LADDER HANDLE #11

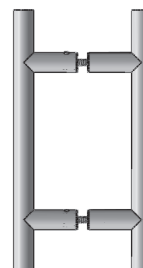

SCREW & ANCHOR #10

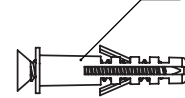

BASE END CAP #15

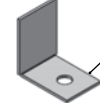

GLASS SCREW HOOK #17



"A" VINYL #9

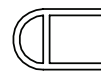

"H" VINYL #8



ROLLER BAR #4

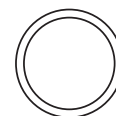

BASE CHANNEL #12



WALL CHANNEL #17



CURB DAM #14



**When ordering replacement parts, please specify the Model Number, Item Number & Part Description. Save these Installation Instructions For Future Reference.**

Write your Dealer information down on Notes Section. Ask your Dealer for JOB LOG NUMBER (Lxxxxxx-xxx) referencing to your shower enclosure.

**STEP 1 Determine the Plumb Condition of the opening:** Use a level to determine that the enclosure is plumb on both sides. If any the door side is OOS (Out Of Square) more than 3/8" or if the panel side is OOS (Out Of Square) more than 5/8" it will make the adjustment of the Glass Doors complicated.

**Detail 1A**

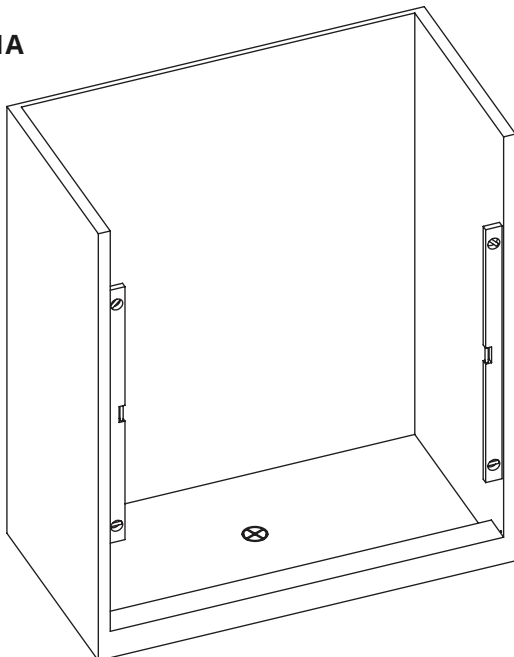

**STEP 1B Determine the Level and Centerline of the Curb**

Determine the level and mark the "high" side of the curb. (A maximum of 3/8" out of level is acceptable. Make a note of the OOS (Out Of Square) measurement for use in Step 4)

**Draw a pencil line side to side on the center line of the Curb.**

**Detail 1B**

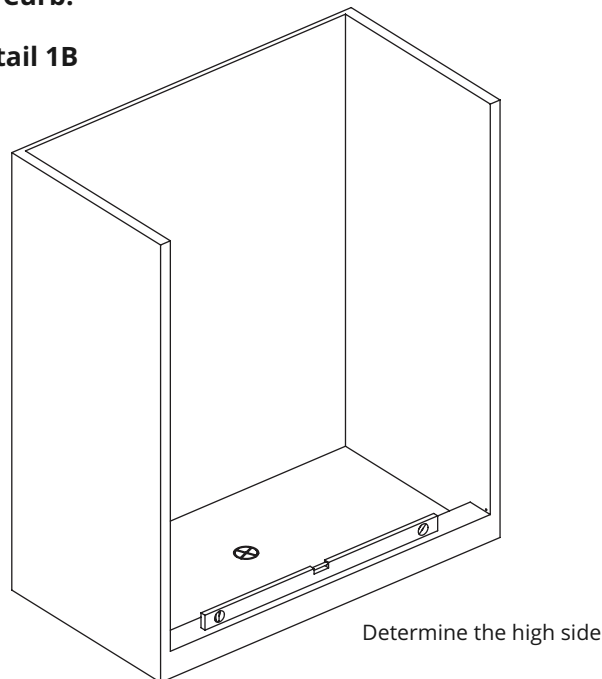

**Detail 1C**

Draw a pencil line front to back on the exact center of the curb.

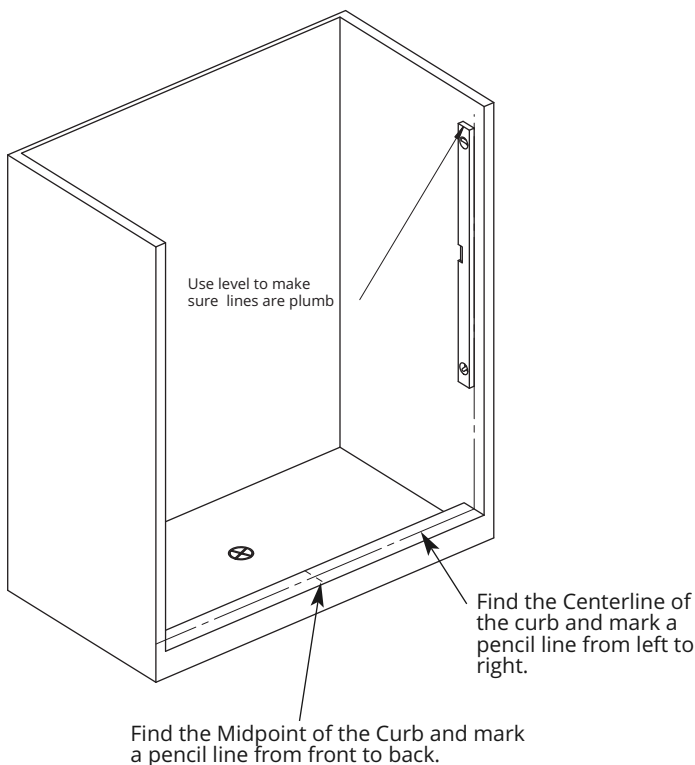

**Detail 2A**

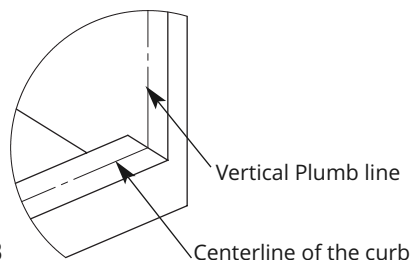
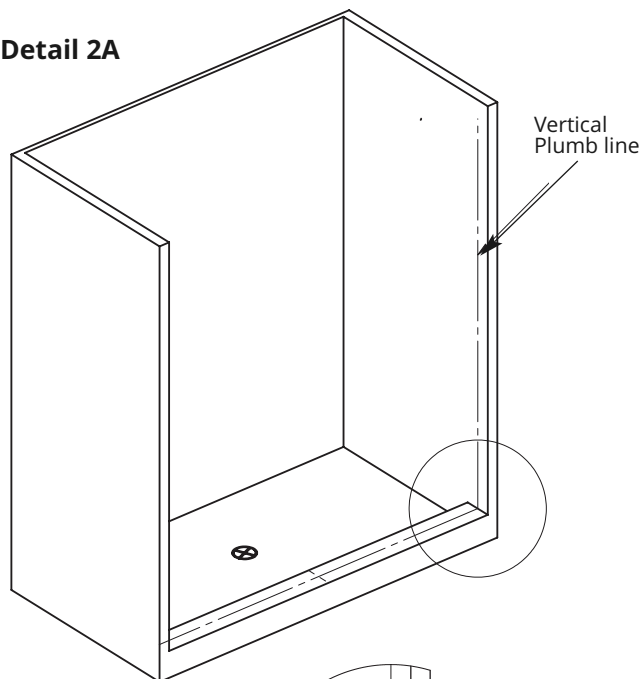

**Detail 2B**

**STEP 2C** Mark the height of the enclosure -- 76" high or 66" high unit.

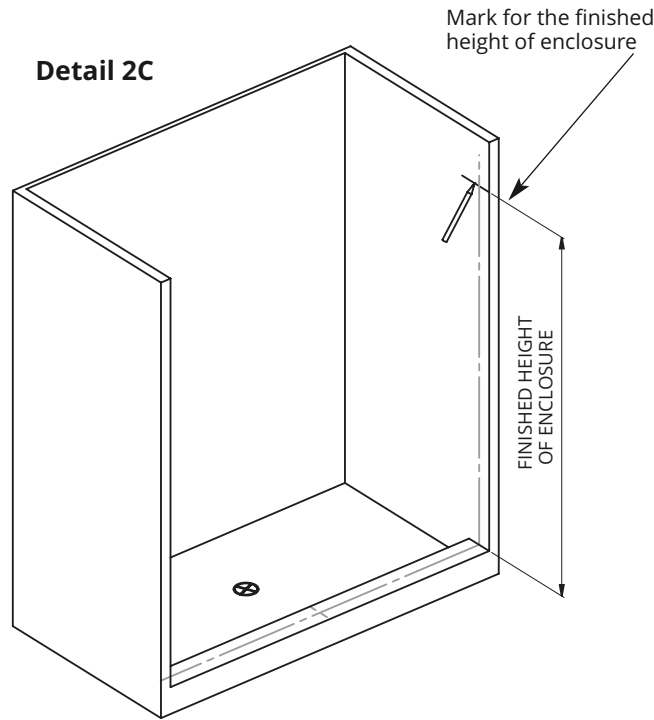

**STEP 3** Drill and install the install the Base Channel for the Fixed Panel Use the Flathead Screws and and anchors as supplied.

**Detail 3A**

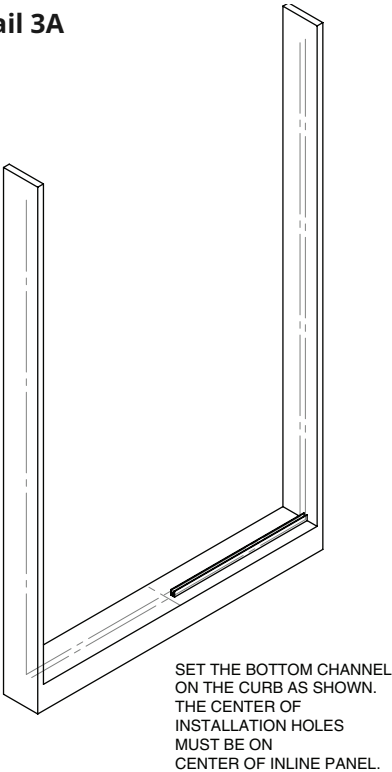

**STEP 2D** Mark another line 15/16" to the outside of the Centerline for the enclosure which will be the centerline fo the fixed panel.

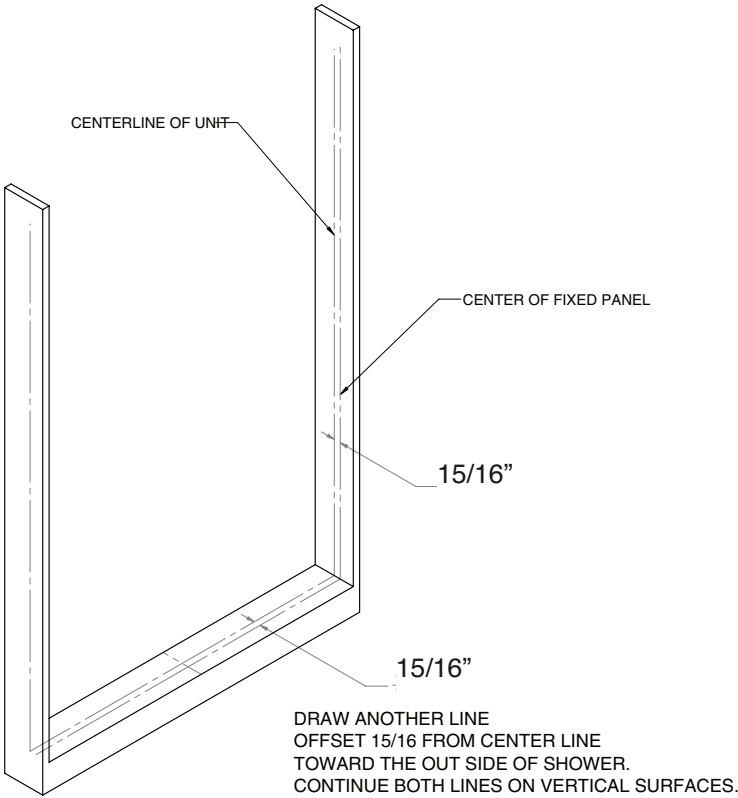

**NOTE:** Silicone each drilled hole before inserting the Anchors

**Detail 3B**

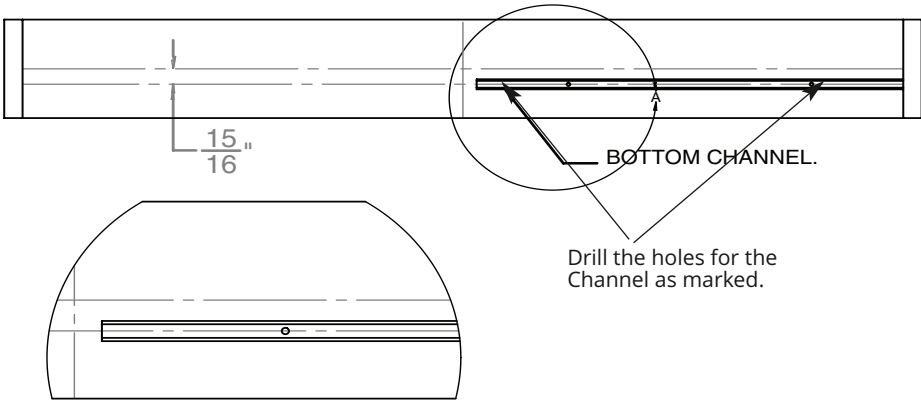

#### STEP 4 Position for Fixed Panel Wall Channel --

Using the measured and marked the plumb location of the centerline for the Wall Channel mark the hole locations and drill and install the anchors.

Place the Wall Channel in position and fix to the wall with the screws provided.

**IMPORTANT NOTE:** Make the adjustment for the OOS (Out Of Square) measurement.

EXAMPLE--If the Curb is OOS  $\frac{3}{8}$ " then the finished height of the enclosure will be plus  $\frac{3}{8}$ " (  $76 \frac{3}{8}$ " or  $66 \frac{3}{8}$ " ).

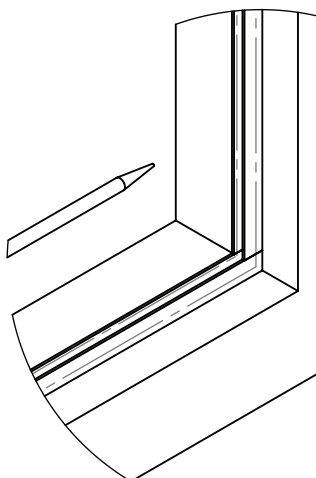
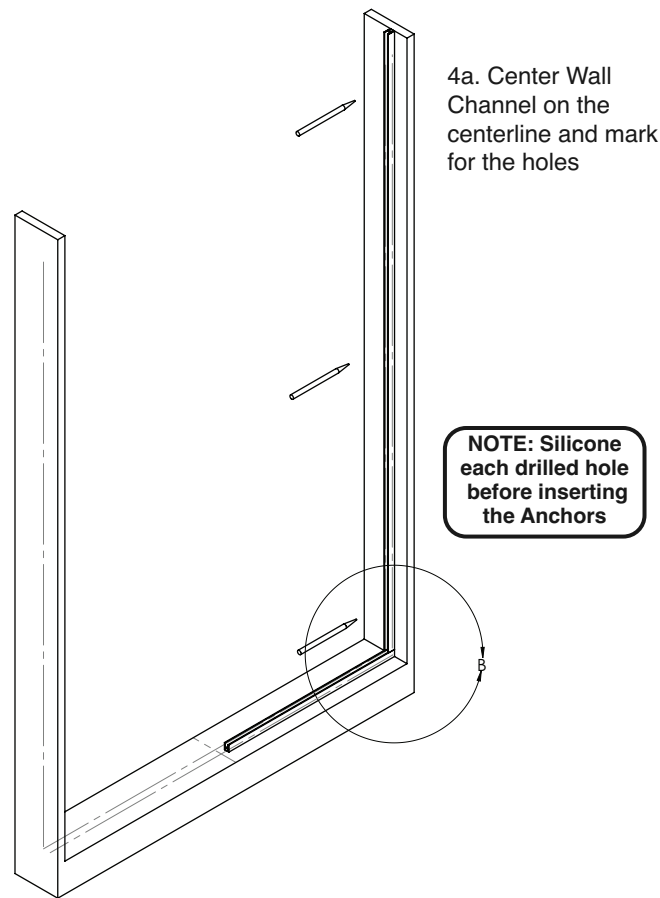

**Detail 4A**

#### STEP 5 Install the Fixed Panel

Place the Glass Shims in the Base Channel

Set the Fixed panel on the shims in the base.

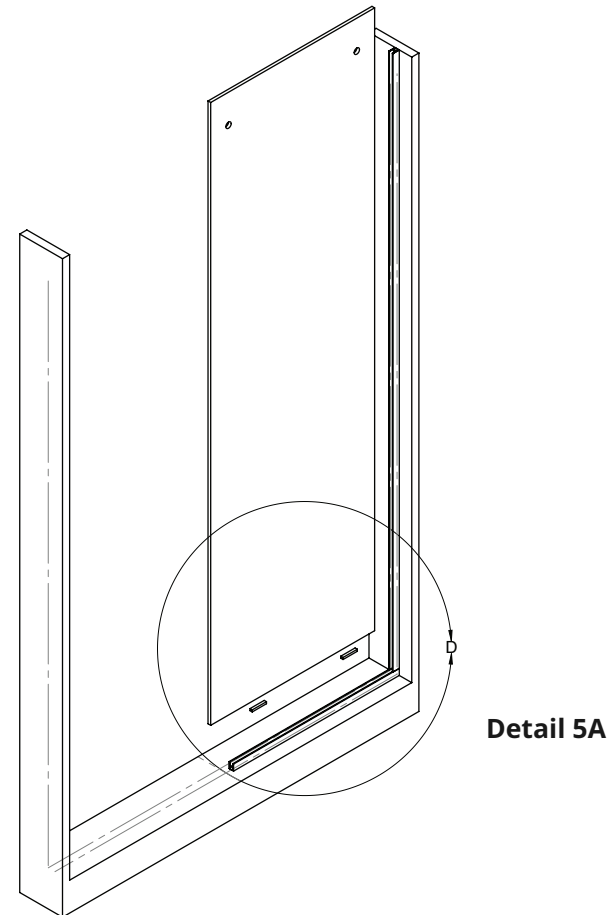

**Detail 5B**

Set Glass Shims inside the Channel

Adjust shims to make edge of glass plumb.

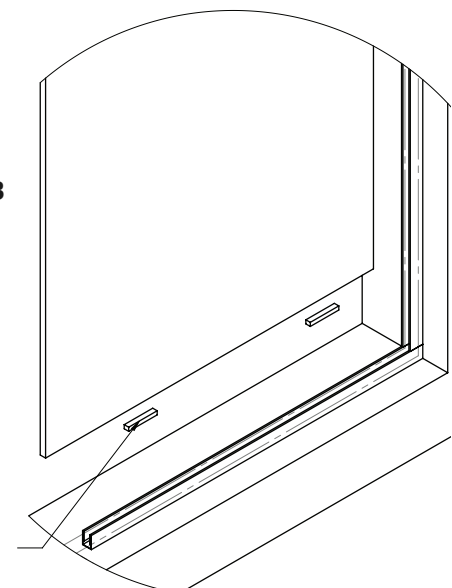



### STEP 5C

Slide the glass panel it into the Wall channel.

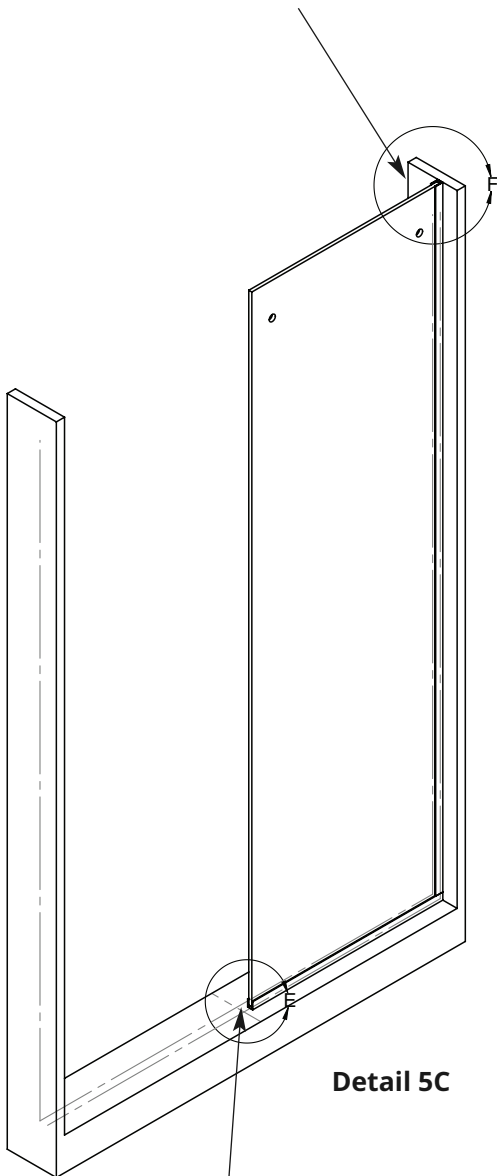

Detail 5C

The Fixed Glass should align with the edge of the Base Channel.

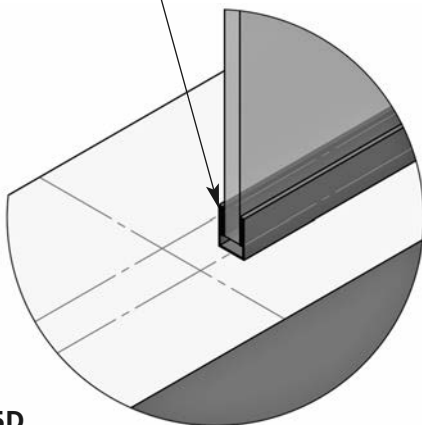

Detail 5D

### STEP 6

The Roller Bar comes with glass screws assembled on it. You must measure and cut the bar to fit. Measure from behind the glass at the height of the predrilled holes in the fixed glass panel. Cut from the end of the bar **opposite the preinstalled glass screws** and make the size as measured .75" (3/4") shorter than the opening to allow for the wall brackets to be installed in Step 8.

#### Detail 6A Shown from the inside:

Measure the opening from behind the glass.

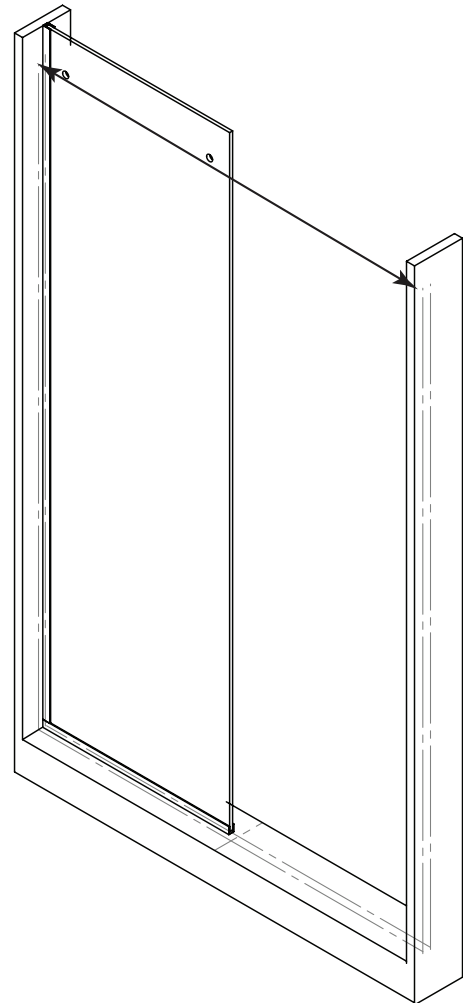

#### Detail 6B

Only cut from this end of the bar (opposite the preinstalled glass screws)

**Cut the bar size as measured .75" (3/4") shorter than the opening.**

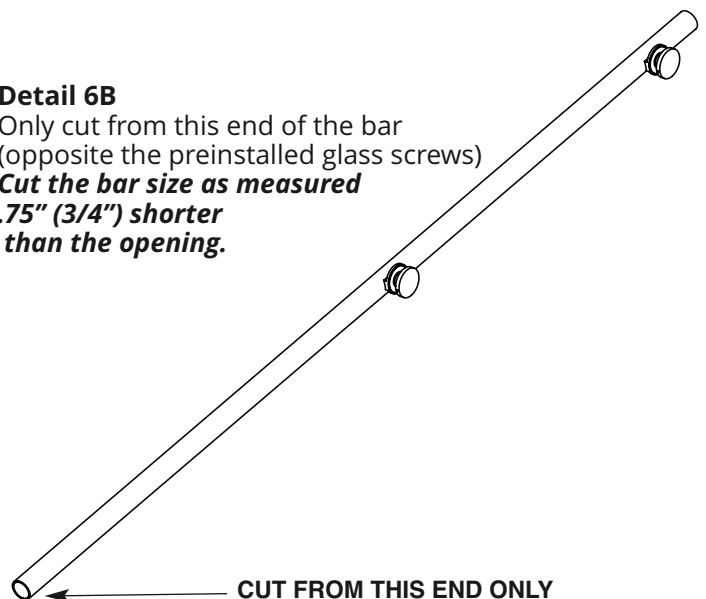

### STEP 7

The Roller Bar attaches from the back of the fixed panel with the glass screws in the front. FINGER TIGHT ONLY. After marking for position of the bar ends, the bar will have to be removed.

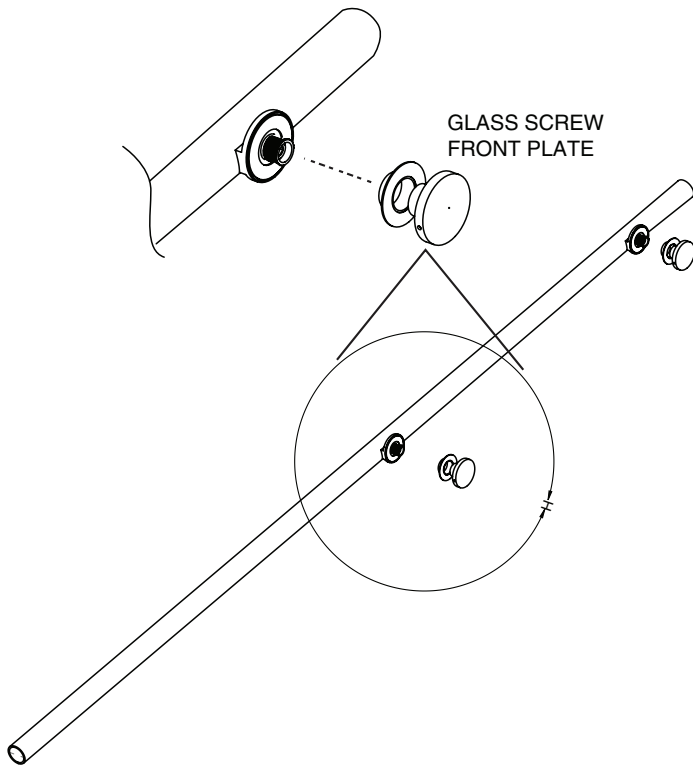

### Detail 7B

Place the level on the Roller Bar as attached to the Fixed Glass Panel. Check and correct for level and plumb.

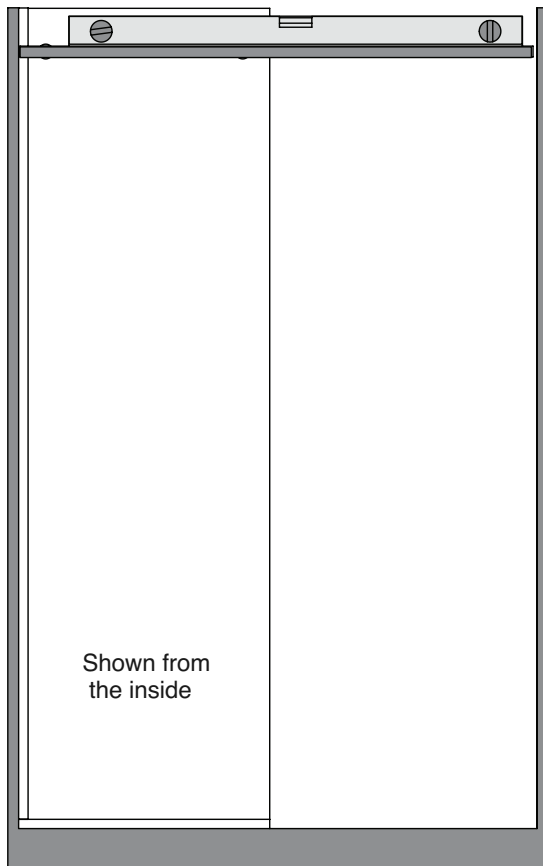

### Detail 7A

Unscrew the front cap from the Glass Screws and attach the Roller Bar to the Fixed Glass Panel.

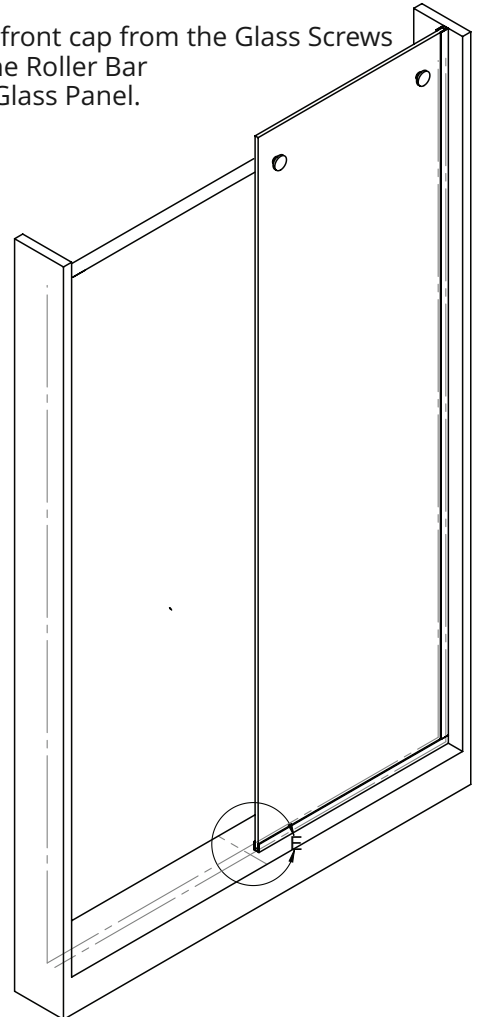

### Detail 7C

Draw a pencil outline of the Roller Bar at each end. This position must be on the center line as previously marked.

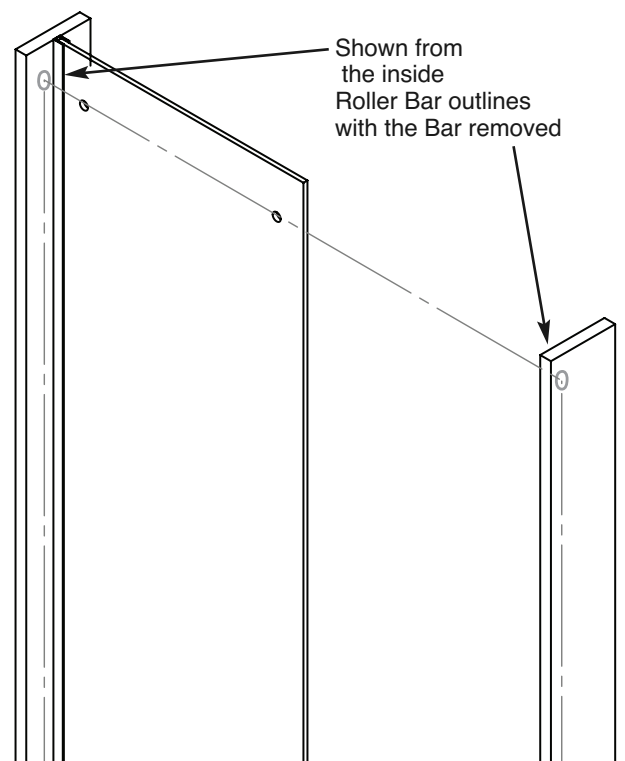

## STEP 8

After drawing the position of the Roller Bar, remove the Bar from the fixed glass.

Remove the fixed glass from the Base and Wall Channel and set aside on a cushioned surface.

Place the Wall Bracket Plate on the marked center line and inside the mark for the Roller Bar, and mark for drilling position.

Drill and insert the wall anchor and screw the Wall Bracket Plate into place on both sides.

**Detail 8A**

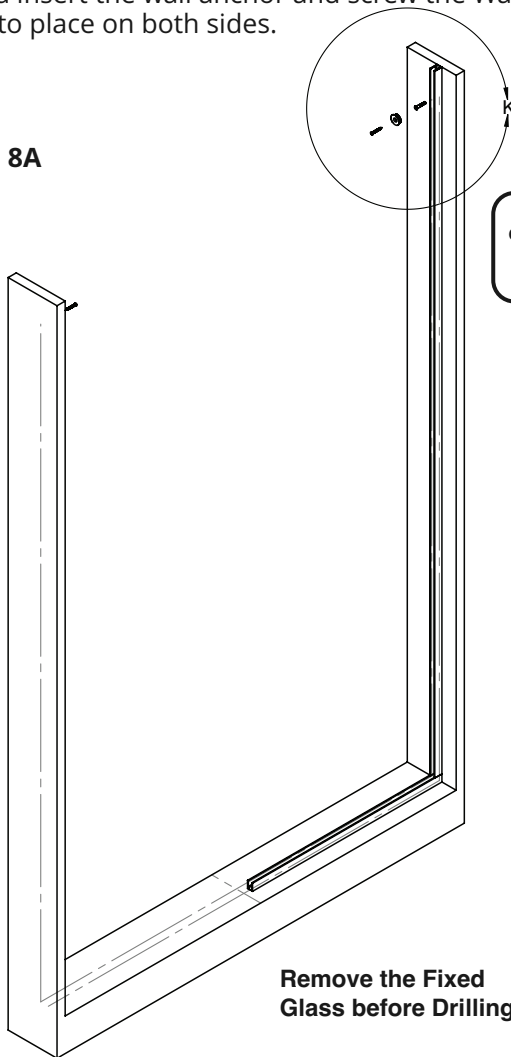

**NOTE: Silicone each drilled hole before inserting the Anchors**

**Detail 8B**

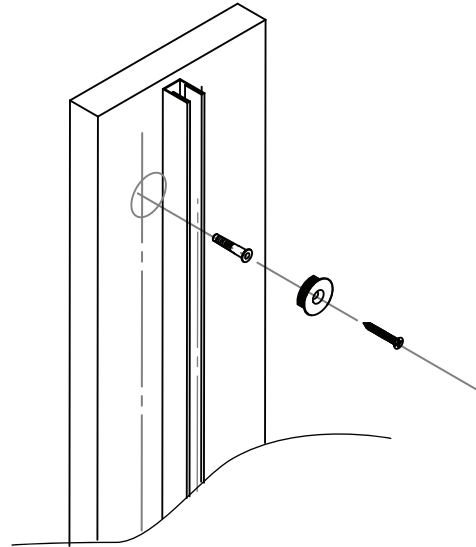

## STEP 9

Install the Base Guide. Set the Base Guide on the Curb with the holes centered on the pencil centerline. Drill and install the screw anchors and fasten the Base Guide with screws.

**Detail 9B**

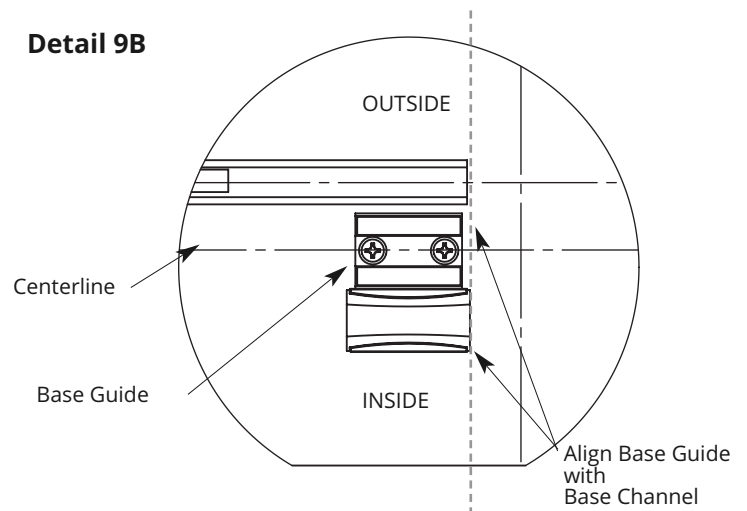

**Detail 9A -- Top View**

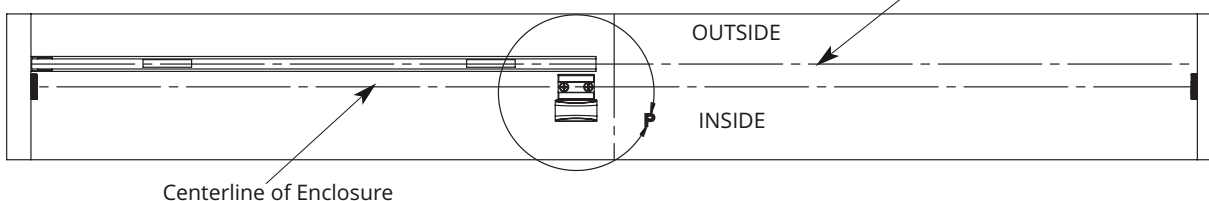

**NOTE: Silicone each drilled hole before inserting the Anchors**

## STEP 10 -- Prepare the Roller Bar with Wall Brackets and Door Stops

1. Remove the Glass Screw that is positioned the end of the bar.
2. Slide the Door Stop onto the bar at this end.
3. Reinstall the Glass Screw using the Glass Screw Hook to position the Glass Bracket in the tube. ( See detail 11B)
4. Slide the Door Stop onto the bar at the other end.
5. Loosen set screws in Wall Bracket Sleeves and slide onto both ends of the bar. Tighten a set screw just to hold in place.

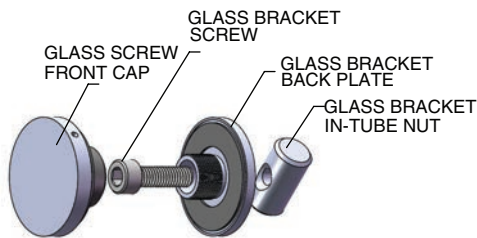
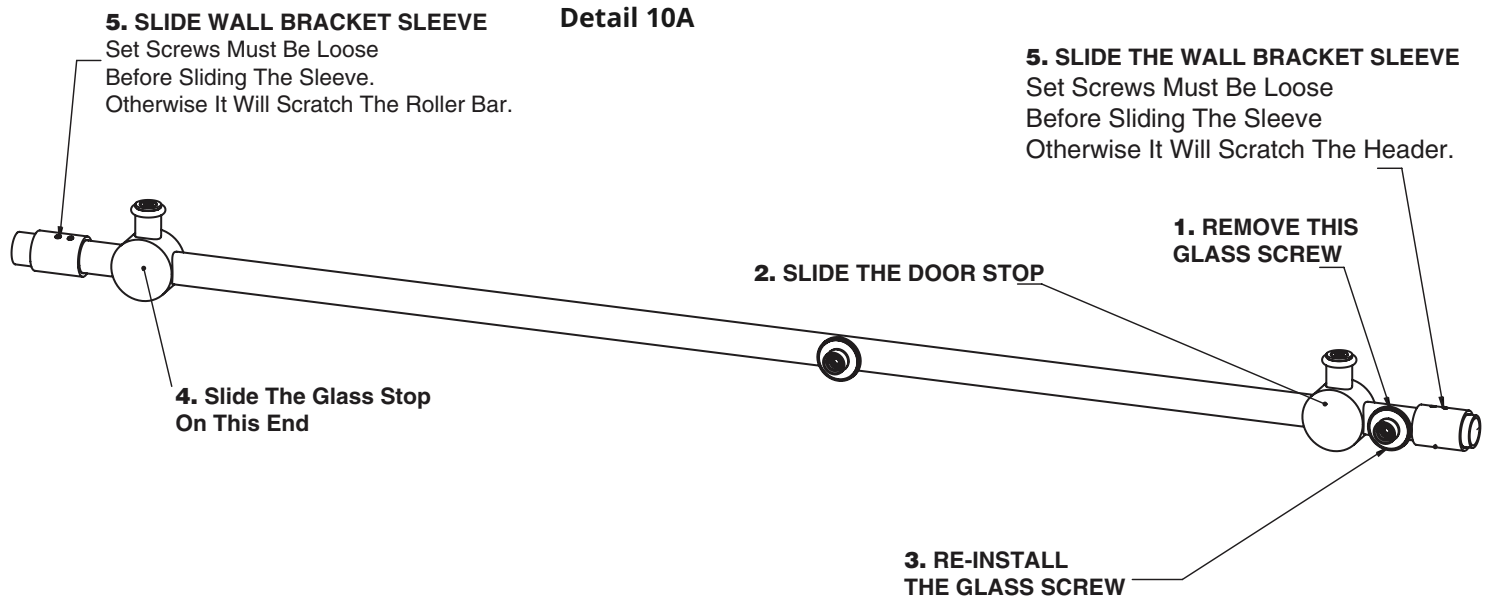

### GLASS SCREW HOOK



### Detail 10C -- Screw Hook

To reinstall the Glass Screw Assembly use the Screw Hook tool to hold the Glass Bracket In-Tube Nut in place inside the Roller Bar to secure the Glass Bracket Screw.

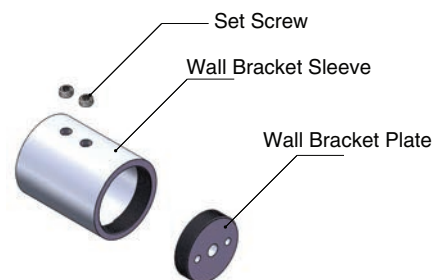
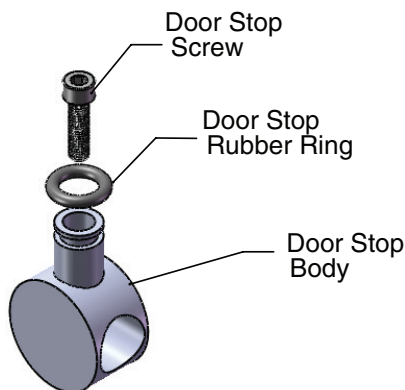

**STEP 11 -- Prepare Door for installation on the Roller Bar**

1. Install the top rollers on the door.
2. Loosen the screw to be able to remove the center pin and roller.
3. Insert the Screw with the Plate Assembly through the glass from the inside and place the Roller and Center Pin on the Screw in the Plate Assembly from the outside and tighten. **Do not tighten completely** as the Plate Assembly has a cam nut incorporated to allow adjustment of the tilt, height and spacing of the glass.  
(See Step 14D for Cam adjustment procedure.)

**IMPORTANT STEP:**

**Move assembled Door into the shower/tub unit and stand it on a cushioned surface with the rollers facing out. This must be done before installing the Roller Bar on the fixed Glass and the Wall.**

**Detail 11C**

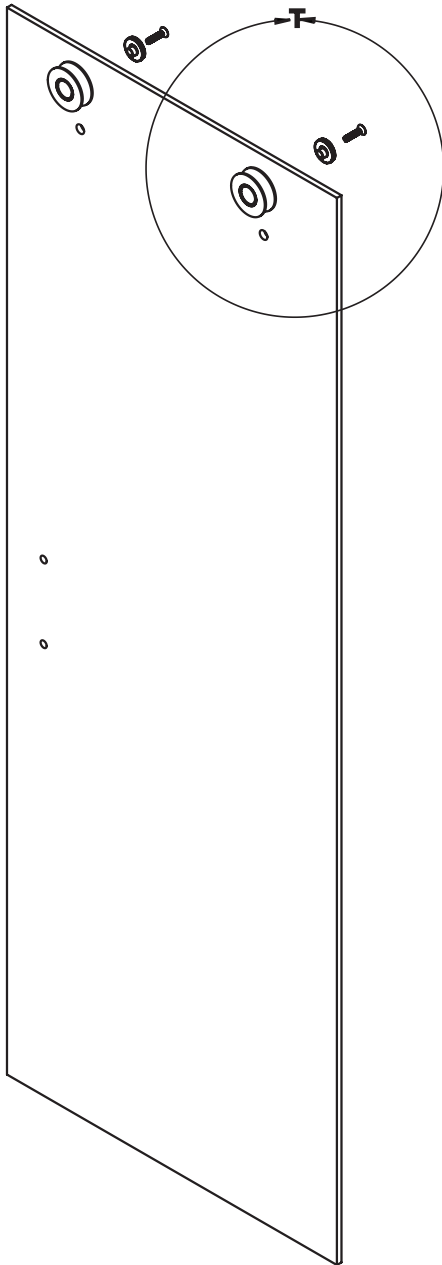

**Detail 11A**

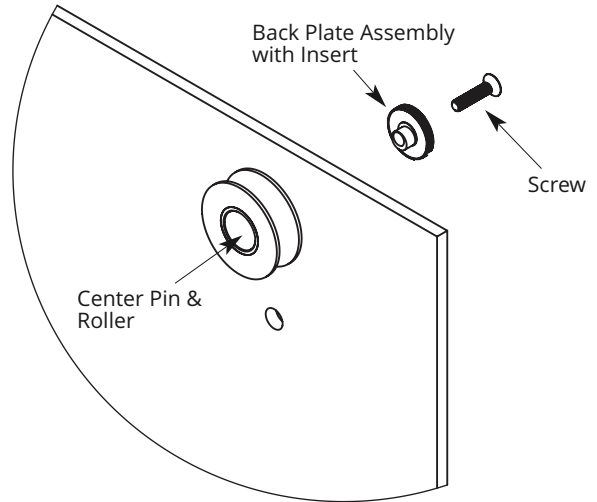

**Detail 11B**

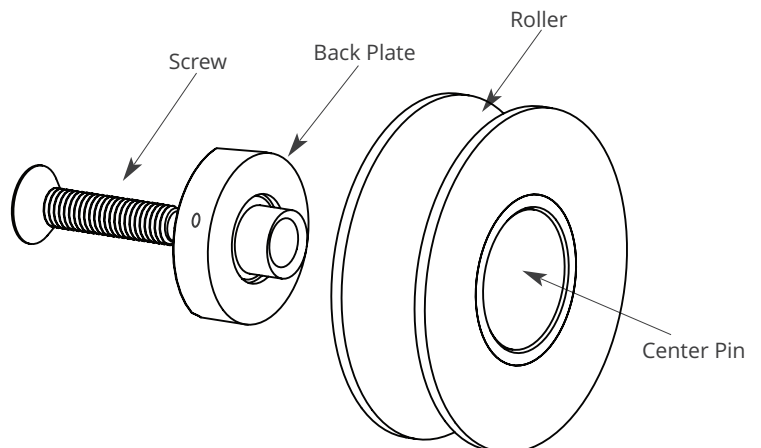

### STEP 12 --

Reinstall the Fixed Glass Panel into the Wall Channel and Bottom Channel with shims. Check for plumb and level. Align the edge of the Glass Panel with the edge of the Base Channel.

Reinstall the assembled Roller Bar on the Fixed Panel.

**Do not tighten the Glass Screws until Installation is complete.**

Slide the Wall Bracket Sleeves over the Bracket Plates and turn them until they are tight with the Wall. Use an Allen Wrench to tighten the set screws.

Tighten the Glass Screw Front Plates. Fasten the Glass screw Caps but **do not tighten the set screws until installation is complete.**

**Detail 12A -- Roller Bar Assembly with Wall Brackets as installed**

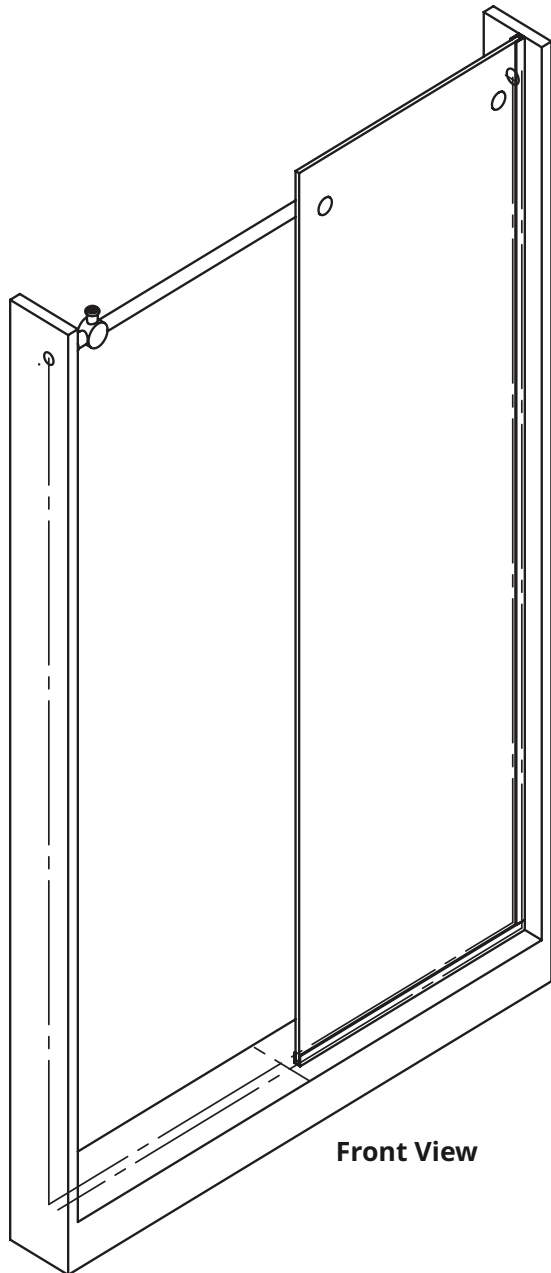

**Front View**

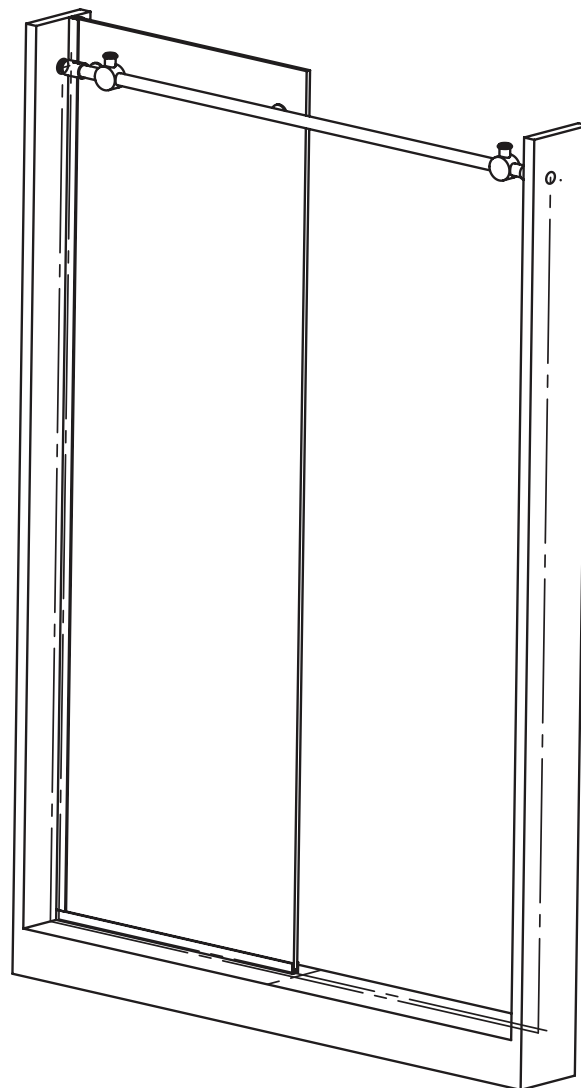

**Inside View**

### STEP 13 -- Hang the Door on the Roller Bar

1. Install the Door from the inside of the unit. Lift straight up and lower on the Roller Bar, making sure that the Door is inside the Center Guide on the curb.
2. Slide the door back and forth to be sure it moves without hesitation.
3. Make sure the top edge of the door and panel are aligned with each other.
4. Move the door close to the wall and make sure the vertical edge of the door is parallel to the wall. (Adjust the tilt of the door if necessary to compensate for the "Out of Square" wall condition.)

**Detail 13A - Assembled Door**

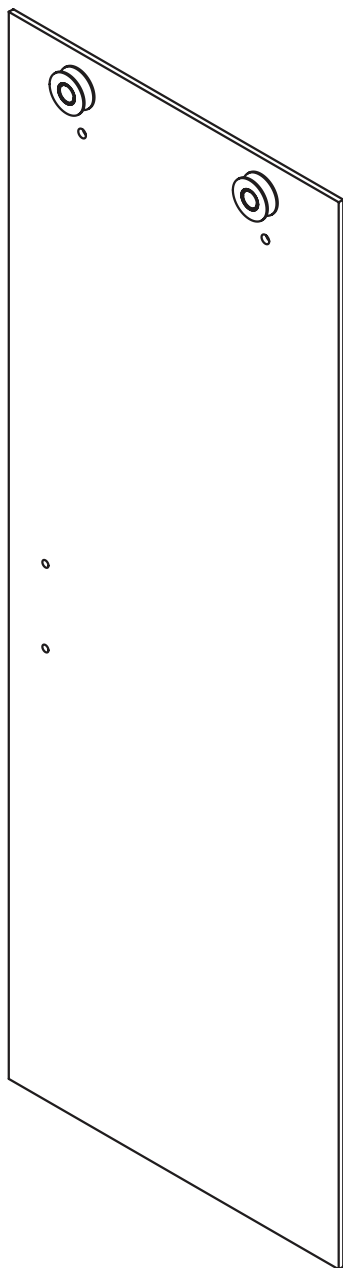

**Detail 13B**

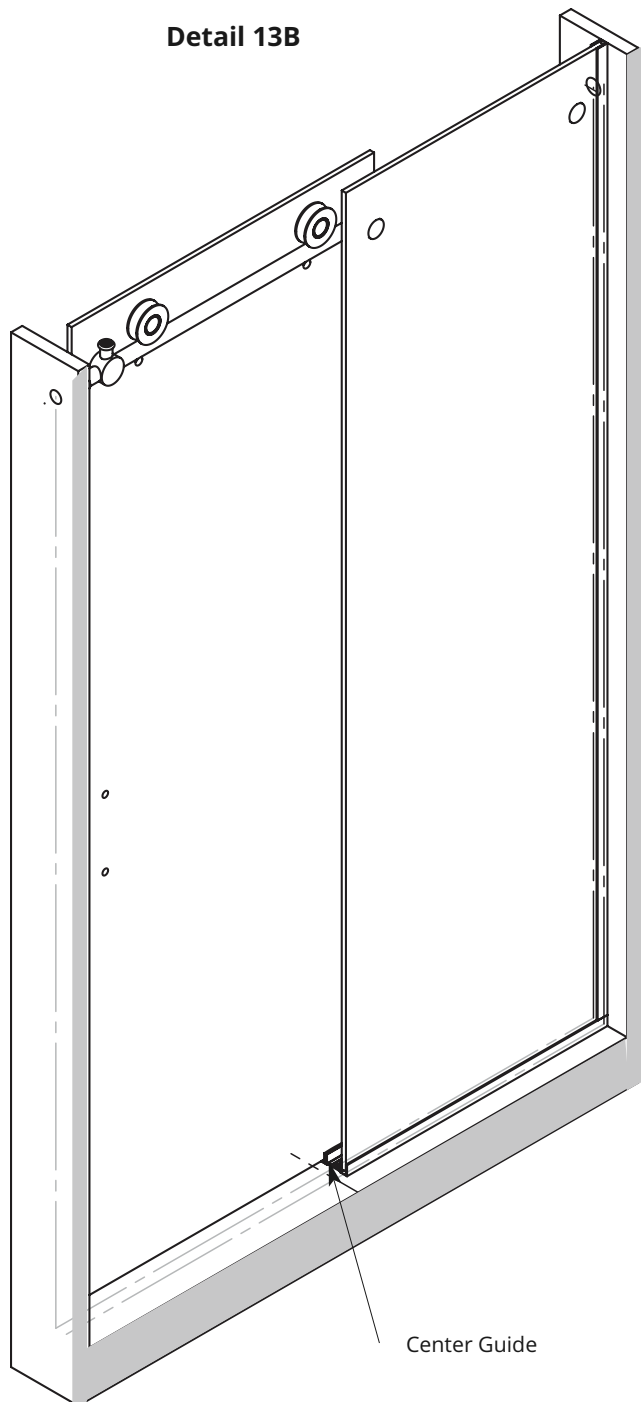

### Step 14 -- Install the Bottom Rollers

1. Install the Bottom Rollers on the door. Follow the same procedure as with the top rollers. The bottom rollers hold the door in place but should not touch the Roller Bar. There should be a  $\frac{1}{32}$ " gap between the Bottom Roller and the Roller Bar.

The Bottom Rollers should not rotate with the movement of the door. The  $\frac{1}{32}$ " gap between the Bottom Roller and the Roller Bar will allow even and quiet operation of the door.

**Detail 14A**

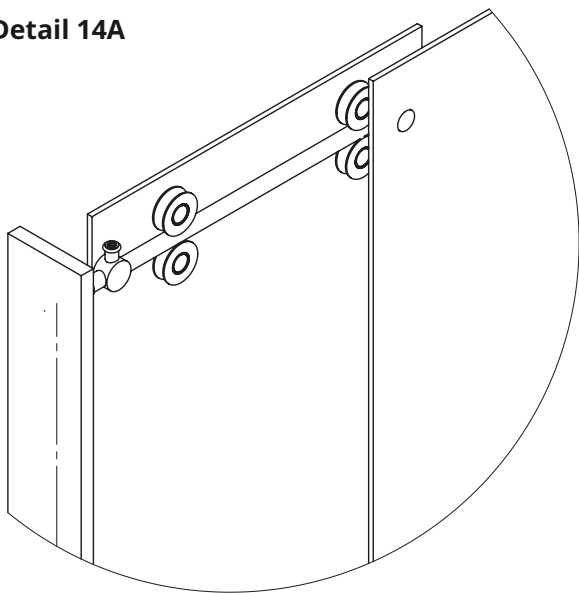

**Detail 14B**

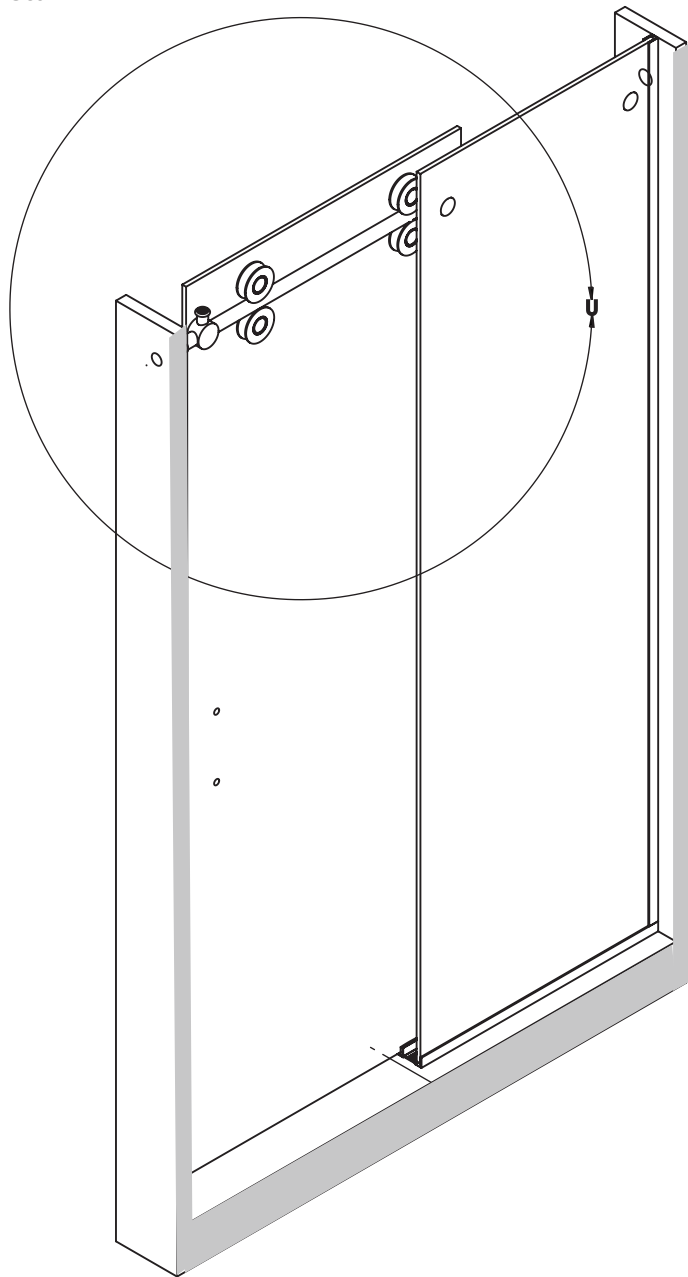

### Step 14D Adjust the Rollers

The Rollers have a cam adjustment that allows adjustment for smooth operation and for changing vertical posting of the door.

1. Use the open end wrench provided to secure the position of the Roller. Insert a pin (not provided) in the hole on the side of the Back Plate and turn it. The cam nut will turn with the pin and move the Glass up and down as needed.

2. Then check for smooth operation and use the Allen Wrench to fasten the back screw of the Roller.

3. These tools can also be used to adjust the Lower Rollers for the proper clearance of  $\frac{1}{32}$ " below the Roller Bar.

**Detail 14D**

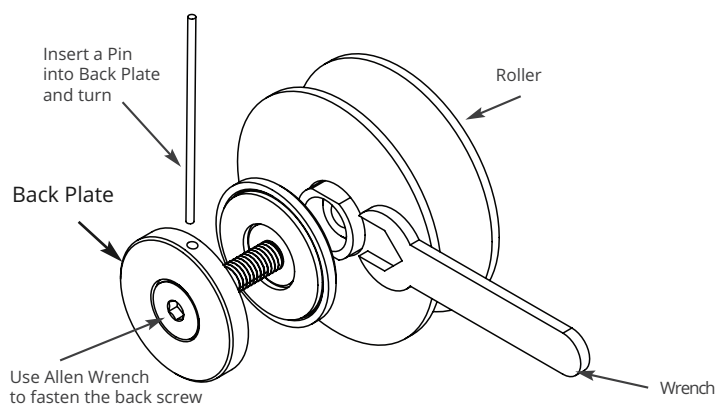

**Detail 14C**

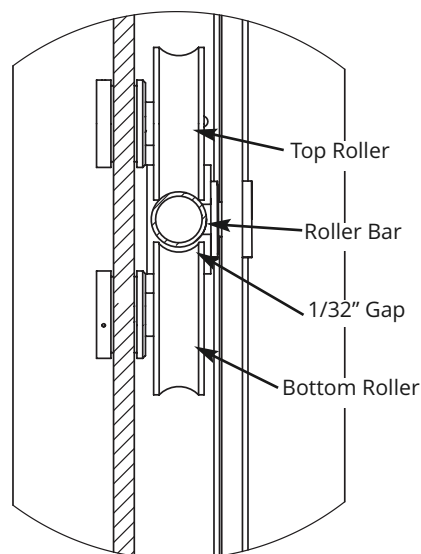



### Step 15 -- Install the "A" Vinyl and Adjust the Closed Position Door Stop

1. Install the "A" Vinyl on the Handle side of the door glass.
2. Move the door to the closed position with the Vinyl touching the wall with slight compression.
3. Hold the door in this position while moving the door stop to the roller until it is touching the top roller.
3. Use the hex wrench to be sure the Door Stop is tight on the Bar.

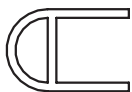

**Detail 15A-- "A" Vinyl top view**

Vinyl should be touching the wall, compressed about 1/16".

Move door stop into position and tightened on the bar.

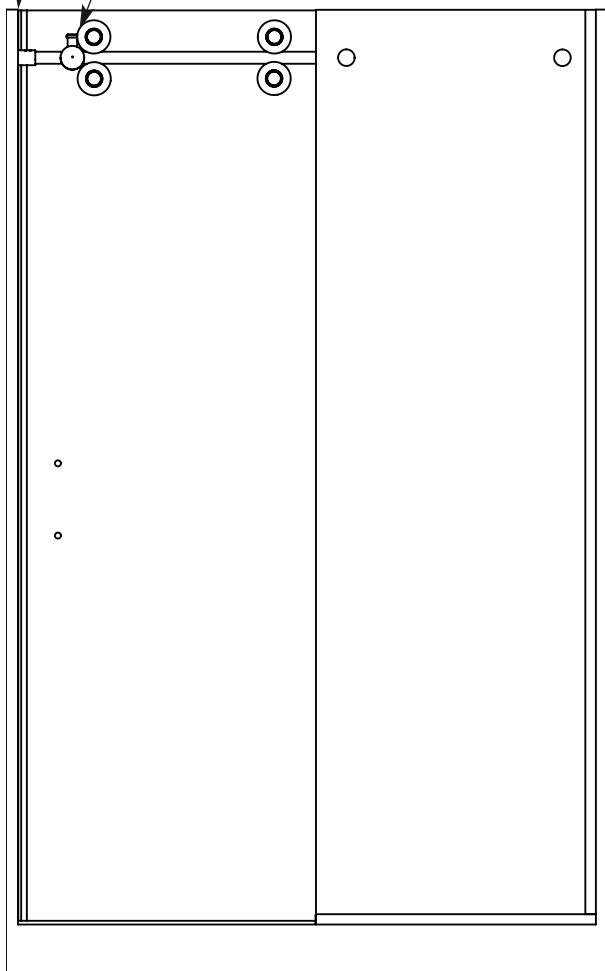

**Detail 15B -- Inside view (closed position)**

### Step 16 -- Install the Door Handle and Adjust for the Open Position Door Stop

1. Install the Handle on the glass.
2. Move the Glass Door to the open position with .75" (3/4") to 1.00" space between the door and the wall.
3. Hold the door in this position while moving the Door Stop to the Roller until it is touching the Top Roller.
3. Use the hex wrench to be sure the Door Stop is tight on the Bar.



**Detail 16A-- Door Handle**

Door in open position with 3/4" to 1" space between door and wall.

Move Door Stop into position and tightened on the Bar.

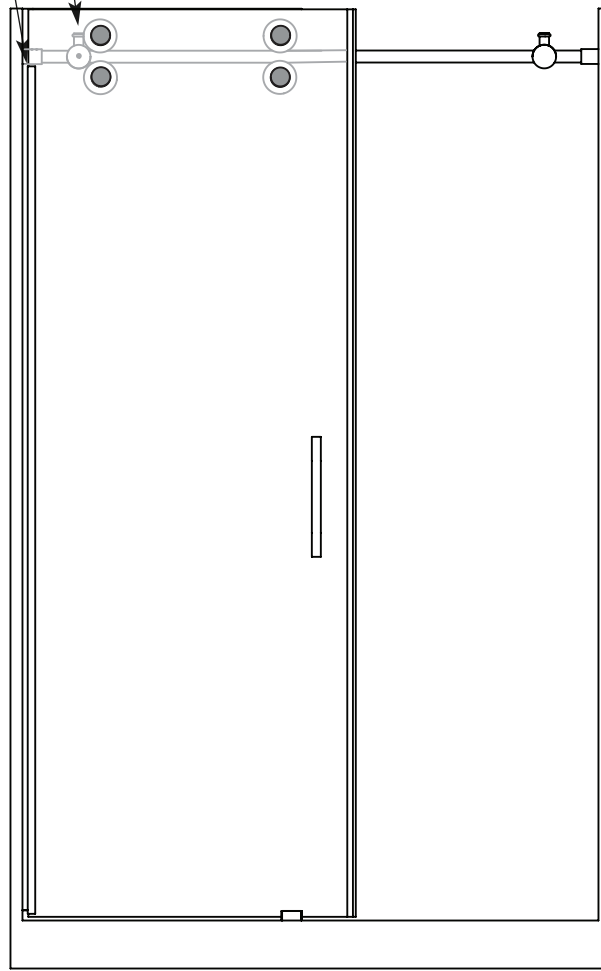

**Detail 16B -- Outside view (open position)**

**Detail 16C -- Top view (open position)**

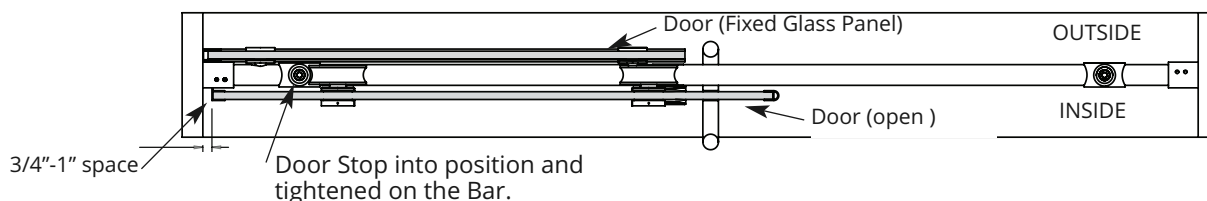

### Step 17 -- Install the Bottom Channel End Cap

1. To install the End Cap squirt a small amount of silicone inside the Base Channel between the bottom of the glass and the floor of the channel. Apply a thin line of silicone on the inside edges of the End Cap and set the End Cap inside the Channel.
2. It is important that the base leg of the End Cap is encapsulated in silicone.
3. Wipe off any excess silicone from the outside face.

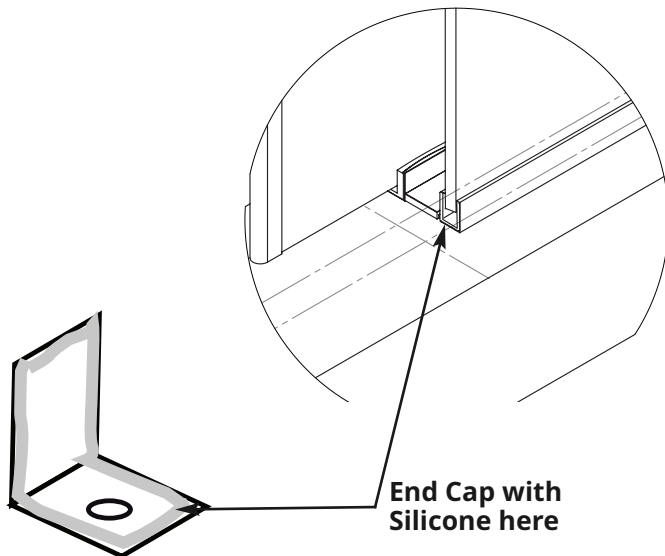

### Step 18 -- Install the Glass Guide Cover Plate

1. Peel off the protective film from the glass guides double face tape and place the Glass Guide Cover Plate in place. Press firmly with fingers to ensure good adhesion.

#### Detail 18

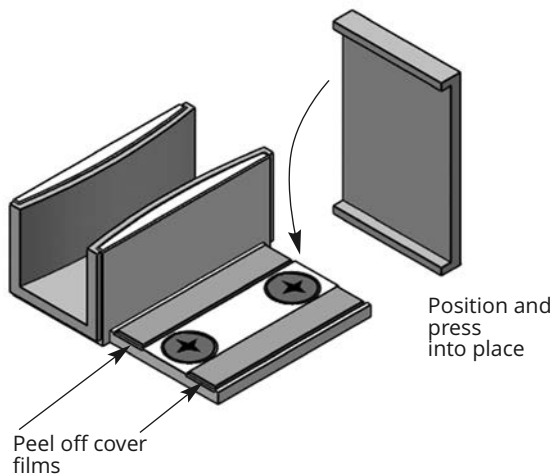

### Step 19 -- Install the Curb Dam

1. The Curb Dam is oversized and must be cut to fit the installation.
2. Measure from the face of the End Cap to the opposite wall on the centerlines as marked. Cut to the measured size with a hack saw with a 32 TPI blade.
3. Check for the fit and remark the proper position with a pencil. Wipe the base of the opening with the appropriate spirits or solvent to be sure the surface is perfectly clean.
4. Peel the protective film from the double face tape on the bottom of the Curb Dam and press firmly into place

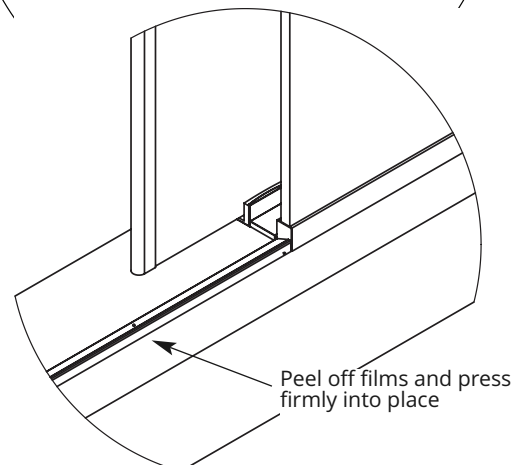
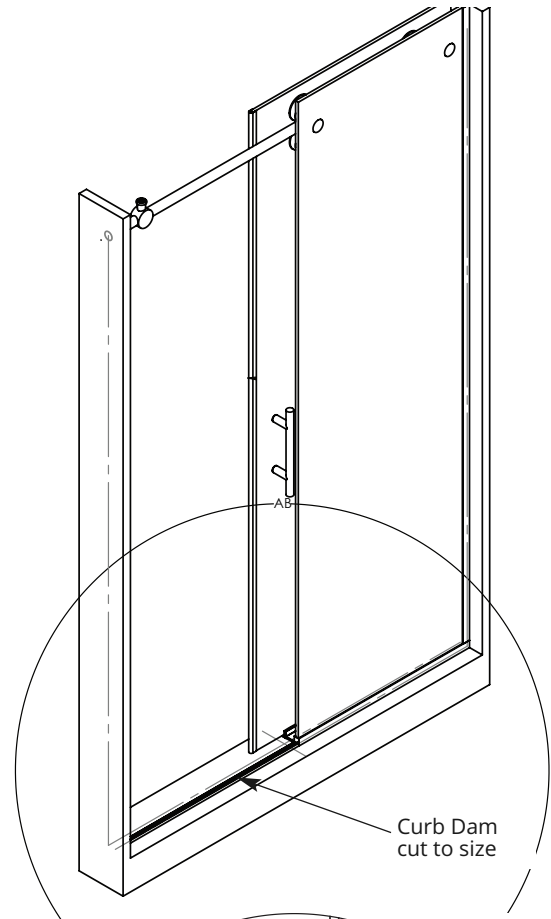

### Step 19 - -Install the "H" Vinyl on the Fixed Glass

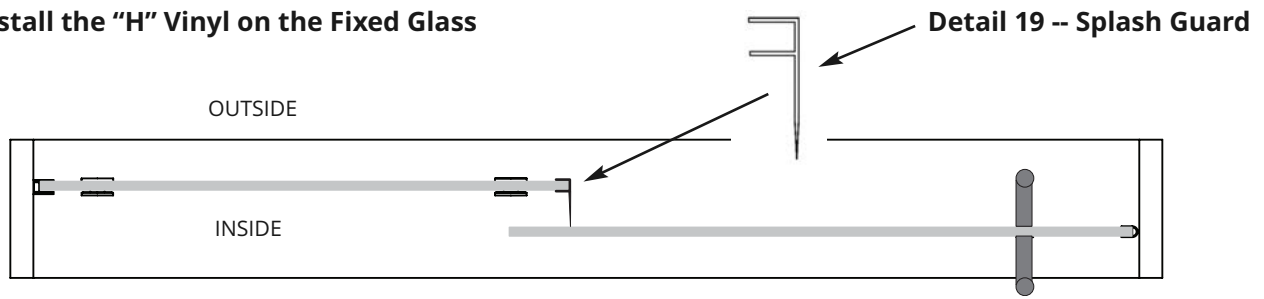

### Step 20 -- Silicon Caulking

1. Run a bead of Silicone on every corner where metal touches stone/stile, both inside and outside the unit.
2. Run a bead of silicone into every corner where glass touches metal channels, both inside and outside of the unit.

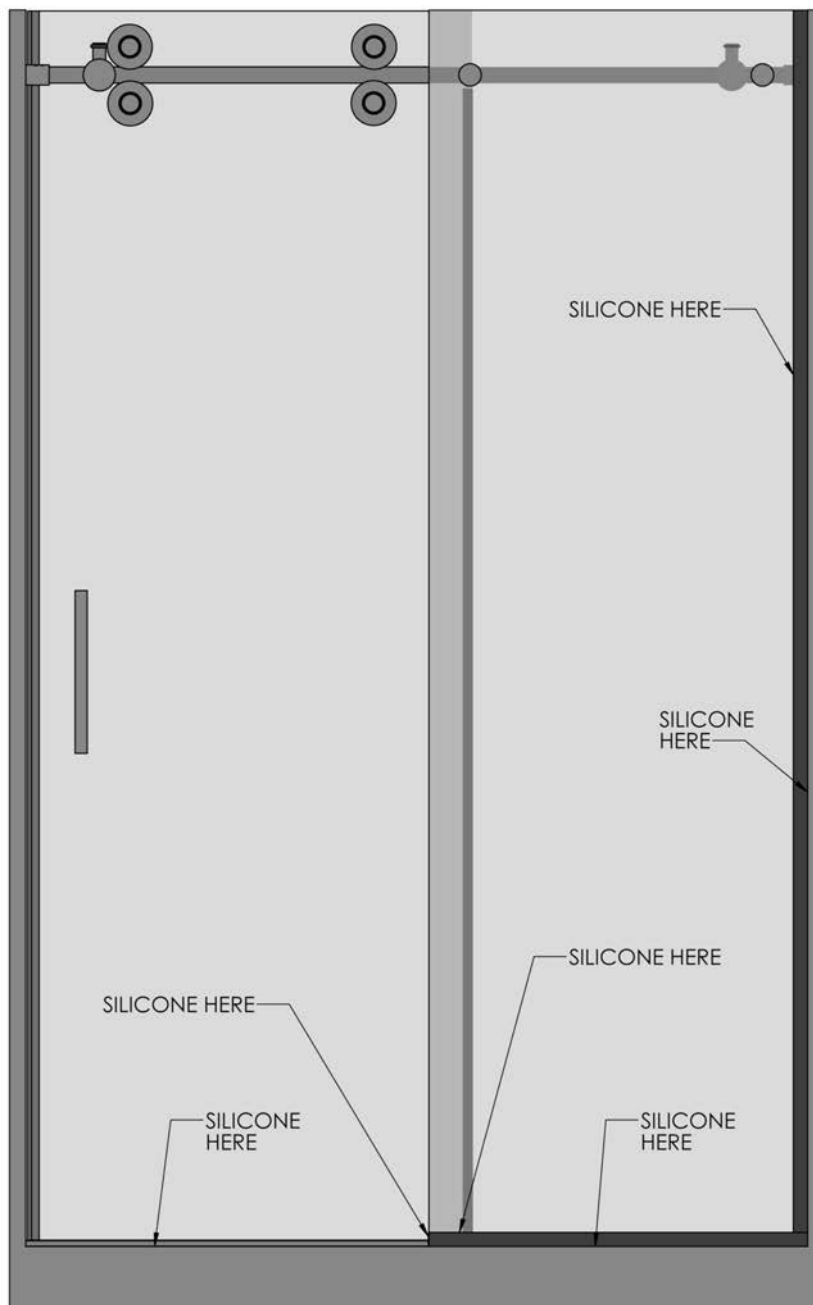

**NOTES:**

---

**CLEANING INSTRUCTIONS:**

Never use scouring powder, pads or sharp instruments on metal work or glass panels. We recommend the use of a squeegee after each shower to eliminate the water spots on the inside of the glass panels. An occasional wiping down on the glass panels and metal parts with a mild detergent , diluted in water, is all that is needed to keep your shower/Tub enclosure looking brand new.

**Cleaning Recommendations:**

**Never use abrasive cleaners or cleaners containing ammonia. This may cause chemical damage .**

For cleaning, we recommend using ammonia free Sprayway brand glass cleaner, which is available at a variety of retail outlets.

[www.spraywayinc.com/content/glass-cleaner](http://www.spraywayinc.com/content/glass-cleaner)



**Model Number...** \_\_\_\_\_

**Dealer** \_\_\_\_\_

**Job Log #** \_\_\_\_\_



GLASSCRAFTERS, INC  
193 Veterans Blvd., Carlstadt, NJ 07072

1+(888) 683-1362 -- (Fax) 201-525-1117  
[sales@glasscraftersinc.com](mailto:sales@glasscraftersinc.com)